

A map of the planned changes

Please note that dog walking rules are staying the same and you will still be allowed to walk your dog without a lead across the park.

The Uplands Arboretum, named to link historically to the Uplands Estate of which the Park was once part. This area already has many significant trees and many more interesting species are to be added to create a aesthetic and educational resource for visitors and schools.

Open area for sports events, casual football, kite flying and rounders.

Enhanced northern entrance with new planting and Knee Rail.

Extension to the existing woodland to create a woodland walk.

All new children's play area set in the sunshine and a large fenced dog free area where families may share picnics, enjoy the gardens and views.

Perennial herbaceous planted in drifts.

Tranquil Garden for outdoor Dance, Yoga and Exercise Classes.

Brand new concrete Skateboard Park for beginners and experts alike.

Possible removal of entrance. State of the art new sports facilities for Basketball, Netball, Tennis, Short Tennis, and Football to be managed by Fareham Leisure Centre. Final layout to be confirmed.

Dense Evergreen planting to screen new sports facilities from houses on Park Lane.

Beech Hedge to Park Lane with timber post and wire fence.

Close access footpath.

Woodland ground cover planting and seasonal bulbs.

Park entrance remodelled and planted to create an attractive feature. Visitors will be welcomed on arrival by Art Work to celebrate the Park.

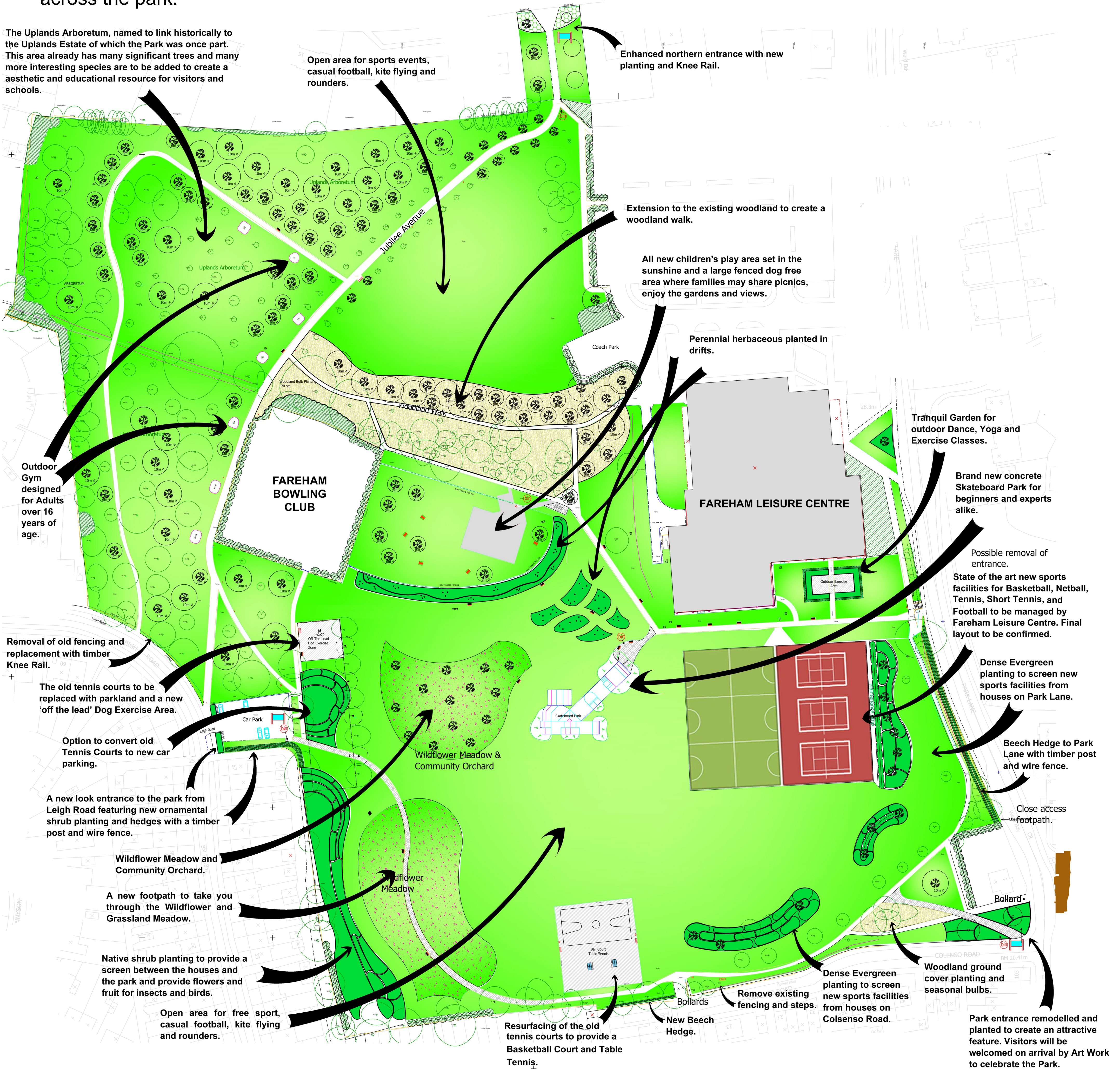

Outdoor Gym designed for Adults over 16 years of age.

Removal of old fencing and replacement with timber Knee Rail.

The old tennis courts to be replaced with parkland and a new 'off the lead' Dog Exercise Area.

Option to convert old Tennis Courts to new car parking.

A new look entrance to the park from Leigh Road featuring new ornamental shrub planting and hedges with a timber post and wire fence.

Wildflower Meadow and Community Orchard.

A new footpath to take you through the Wildflower and Grassland Meadow.

Native shrub planting to provide a screen between the houses and the park and provide flowers and fruit for insects and birds.

Open area for free sport, casual football, kite flying and rounders.

Resurfacing of the old tennis courts to provide a Basketball Court and Table Tennis.

Remove existing fencing and steps.

New Beech Hedge.

Dense Evergreen planting to screen new sports facilities from houses on Colsenso Road.

Woodland ground cover planting and seasonal bulbs.

- | | | |
|--|--------------------|--|
| Refuse Bins | Arboretum Tree | Large Arboretum Tree |
| Feature Plants | New Paths | Table Tennis Table |
| Existing Vegetation | Existing Trees | New Seating |
| New Shrub and Herbaceous Planting | New Tree | Interpretation Boards
New Picnic Tables |
| Grass | Tree to be removed | |
| New Wildflower or Woodland Bulb Planting | | |