

FAREHAM

BOROUGH COUNCIL

ANTI SOCIAL BEHAVIOUR, CRIME AND POLICING ACT 2014

PART 4, SECTION 59

PUBLIC SPACES PROTECTION ORDER (DOG CONTROL) 2019

This Order comes into force on the [1 April 2019] and will remain in force for a period of three (3) years from that date unless extended by further order under the Council's statutory powers.

Fareham Borough Council ("the Council") in exercise of its powers under section 59 of the Anti-Social Behaviour, Crime and Policing Act 2014 ("the Act") being satisfied that the conditions set out in section 59 of the Act have been met makes the following Order: -

1. General provisions

Definitions

- 1.1 "Authorised Officer" means any officer of the Authority authorised by the Chief Executive of the Authority for the purposes of paragraphs 4 and 5 of the Order.
- 1.2 "Public Place" means any place in the administrative area of the Authority to which the public or a section of the public has access, on payment or otherwise, as of right by virtue of express or implied permission. The administrative area of the Authority is the land edged black in Schedule 1.
- 2.1 "Person in Charge" A person who habitually has a dog in his possession shall be taken to be in charge of the dog at any time unless at that time some other person is in charge of the dog.

Offence and Penalty

- 2.2 It is an offence under Section 67 of the Act for a person without reasonable excuse, (i) to do anything that they are prohibited from doing under the Order or (ii) to fail to comply with a requirement which they are subject to under the Order. A person guilty of an offence under section 67 is liable on summary conviction to a fine not exceeding level 3 on the standard scale.

3. Fouling

- 3.1 The public health implications of dog fouling are well documented. This part and part 4 of the order are designed to prevent contamination of public spaces by dog faeces.
- 3.2 If a dog defecates at any time on any Public Place the person who is in charge of the dog at the time must remove the faeces forthwith unless;

- (a) they have a reasonable excuse for failing to do so; or
 - (b) the owner, occupier or other person or authority having control of the Public Place has consented (generally or specifically) to them failing to do so.
- 3.3 Placing the faeces in a receptacle which is provided for that purpose, or for the disposal of waste, shall be sufficient removal from the Public Place.
- 3.4 Not being aware of the defecation or not having a device for or suitable means of removing the faeces shall not be a reasonable excuse for failing to remove it.
4. Dogs on Lead by Direction
- 4.1 In public places in the Borough of Fareham where dogs are permitted off leads, a minority of persons in charge of dogs allow them to cause damage to property, and cause problems for pedestrians and other dog owners. This part of the Order is designed to enable authorised Council Officers to direct that such a person put their dog on a lead.
- 4.2 An Authorised Officer may on any Public Place (other than those specified in Schedules 2 and 3 of the Order from which dogs are excluded from or must be kept on a lead in any event) direct a person in charge of a dog to keep the dog on a lead if such restraint is in the opinion of the Authorised Officer necessary to prevent nuisance to other persons or worry to animals.
- 4.3 A person issued with a direction under paragraph 5.1 of the Order must comply unless;
- (a) they have a reasonable excuse for failing to do so; or
 - (b) the owner, occupier or other person or authority having control of the Public Place has consented (generally or specifically) to them failing to do so.
5. Maximum of four dogs
- 5.1 There has been an increase in the number of persons and businesses walking numbers of dogs together, and some of these persons have exercised poor control over these dogs. This has caused problems for other dog owners and has also resulted in dog foul not being picked up. This part of the Order seeks to place limits on the number of dogs which may be walked together to enable greater control.
- 5.2 A person shall not at any time take more than four dogs on to any Public Place (other than those specified in Schedule 3 of the Order from which dogs are excluded in any event)
- 5.3 A person must comply with the requirement in paragraph 6.1 of this Order unless;
- (a) they have a reasonable excuse for failing to do so; or
 - (b) the owner, occupier or other person or authority having control of the Public Place has consented (generally or specifically) to them failing to do so.
6. Dogs on Leads
- 6.1 In some public places within the Borough of Fareham that are sensitive because of their nature or usage, or which are fragile environments, close control of dogs by their being on a lead is necessary to prevent damage or undue disturbance. The restrictions in this Order are designed to facilitate a sharing of these public places, whilst recognising that dogs do need to be exercised off lead.

- 6.2 A person in charge of a dog on any Public Place specified in Schedule 2 to the Order must keep the dog on a lead unless
- (a) they have a reasonable excuse for failing to do so; or
 - (b) the owner, occupier or other person or authority having control of the place has consented (generally or specifically) to them failing to do so.
7. Exclusion of dogs
- 7.1 There are specific public places in the Borough of Fareham from which dogs should be excluded for their safety and that of members of the public, and for public health and aesthetic reasons. This part of the Order states the relatively few places from where dogs will be excluded.
- 7.2 A person in charge of a dog must not take it into or keep it in any Public Place specified in Schedule 3 to the Order unless
- (a) they have a reasonable excuse for doing so; or
 - (b) the owner, occupier or other person or authority having control of the Public Place has consented (generally or specifically) to them failing to do so.
8. Exemptions
- 8.1 Nothing in this Order shall apply to a person who: -
- a) Is registered as a blind person on a register compiled under Section 29 of the National Assistance Act 1948; or
 - b) Is deaf, in respect of a dog trained by Hearing Dogs for Deaf People (registered charity number 293358) and upon which he relies for assistance; or
 - c) Has a physical or mental impairment which has a substantial and long term adverse effect on the ability to carry out normal day-to-day activities, in respect of a dog trained by any current or future member of Assistance Dogs UK or any other charity registered in the UK with a purpose of training assistance dogs and upon which he relies for assistance.
 - d) Has a physical or mental impairment which has a substantial and long term adverse effect on the ability to carry out normal day-to-day activities and in the reasonable opinion of the Council that person relies upon the assistance of the dog in connection with their disability.

EXECUTED AS A DEED BY AFFIXING THE COMMON SEAL OF FAREHAM BOROUGH COUNCIL IN THE PRESENCE OF:

SOLICITOR



F.122

-SCHEDULE 1-
Administrative Area of the Borough of Fareham

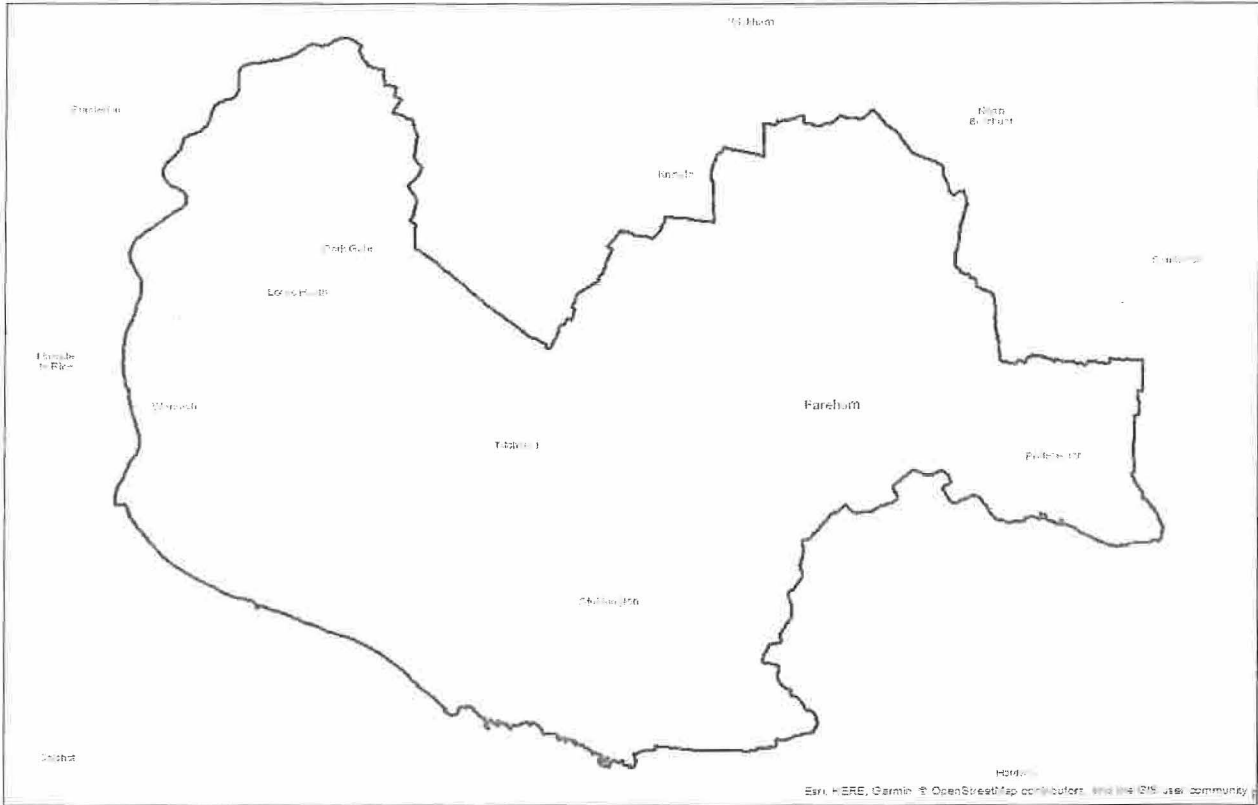

FAREHAM
BOROUGH COUNCIL

Administrative Area of Fareham

© Crown copyright and database right 2018 Ordnance Survey 100019110. You are permitted to use this data solely to enable you to reproduce or retransmit with the permission of the organization that provided you with the data. You are not permitted to copy, distribute, create out, or sell any of the data to third parties in any form.

-SCHEDULE 2-

PARAGRAPH 7 "DOGS ON LEADS"

This Order applies to the following Public Places in the Borough of Fareham

1. Any Cemetery or churchyard
 Crofton Cemetery, Oakcroft Lane, Stubbington
 Wickham Road Cemetery, Fareham St Peter's Cemetery, Church Street, Titchfield,
 Posbrook Lane Cemetery, Titchfield,
 Roman Grove Cemetery, Castle View Road, Portchester,
 St Johns Cemetery, St Johns Road, Locks Heath,
 St Paul's Cemetery, Barnes Lane, Sarisbury
 Holly Hill Cemetery, Barnes Lane, Sarisbury

 St Peter and St Paul's Churchyard, Osborn Road, Fareham
 St Peter's Churchyard, Church Street, Titchfield
 Crofton Churchyard, Lychgate Green, Stubbington
 St Mary's Churchyard, Castle Street, Portchester
 St Paul's Churchyard, Barnes Lane, Sarisbury
2. Westbury Manor Museum Garden, Fareham Town Centre
3. Sensory Garden of Reflection, Osborn Road, Fareham
4. Salterns Road Promenade, Hill Head (*refer to plan*)
5. Holly Hill Woodland Park (*refer to plan*)
6. Holly Hill Play Area (*refer to plan*)
7. Burr ridge Pond (*refer to plan*)
8. Coldeast Open Space (*refer to plan*)
9. Any area within Fareham that is:
 - i). Designated as a Site for Special Scientific Interest ("SSSI") or; ii), where the Authority keep animals and where signage is present;
 - a) Portchester Common (*refer to plan*)
 - b) Abbey Meadows (*refer to plan*)

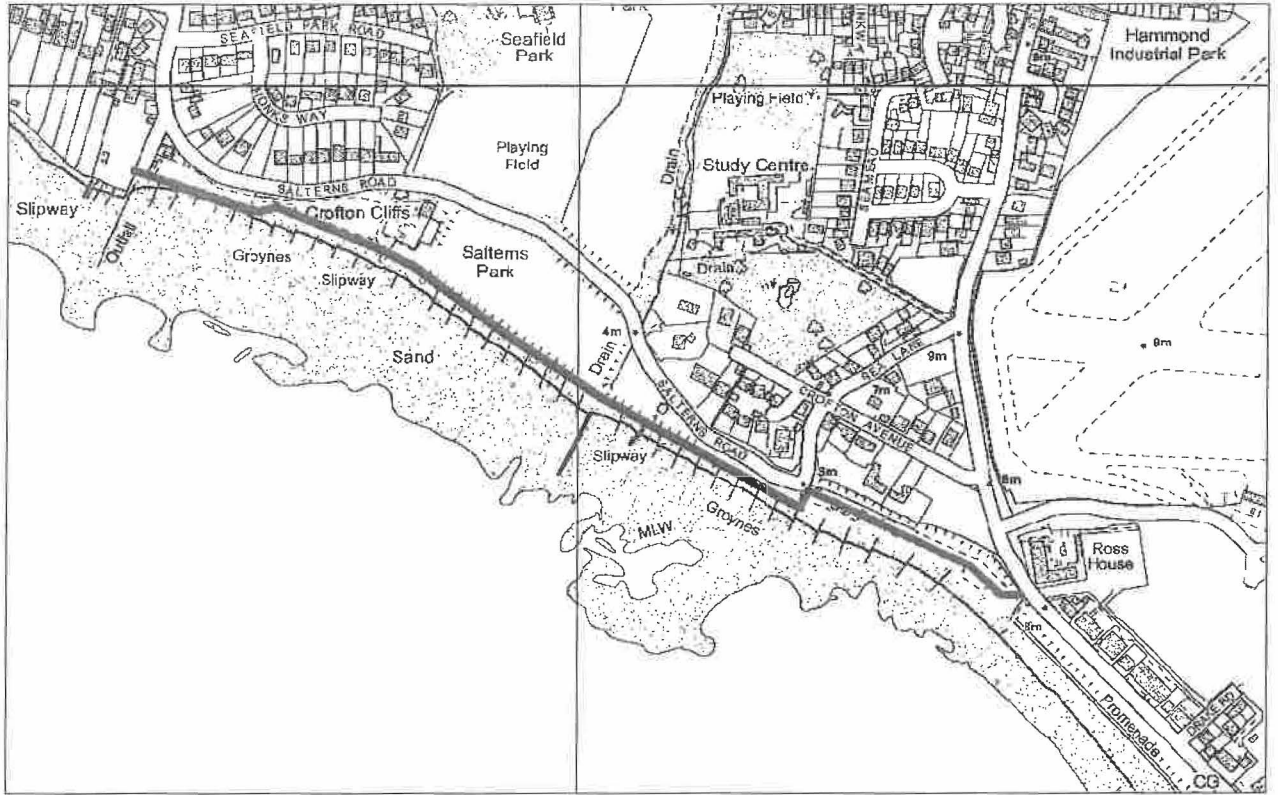

FAREHAM
BOROUGH COUNCIL

Salterns Road Promenade, Hill Head

© Crown copyright and database right 2018 Ordnance Survey 100019160. You are permitted to use this data solely to enable you to respond to, or interact with, the organisation that provided you with the data. You are not entitled to copy, re-transmit, distribute or sell any of this data to third parties in any form.

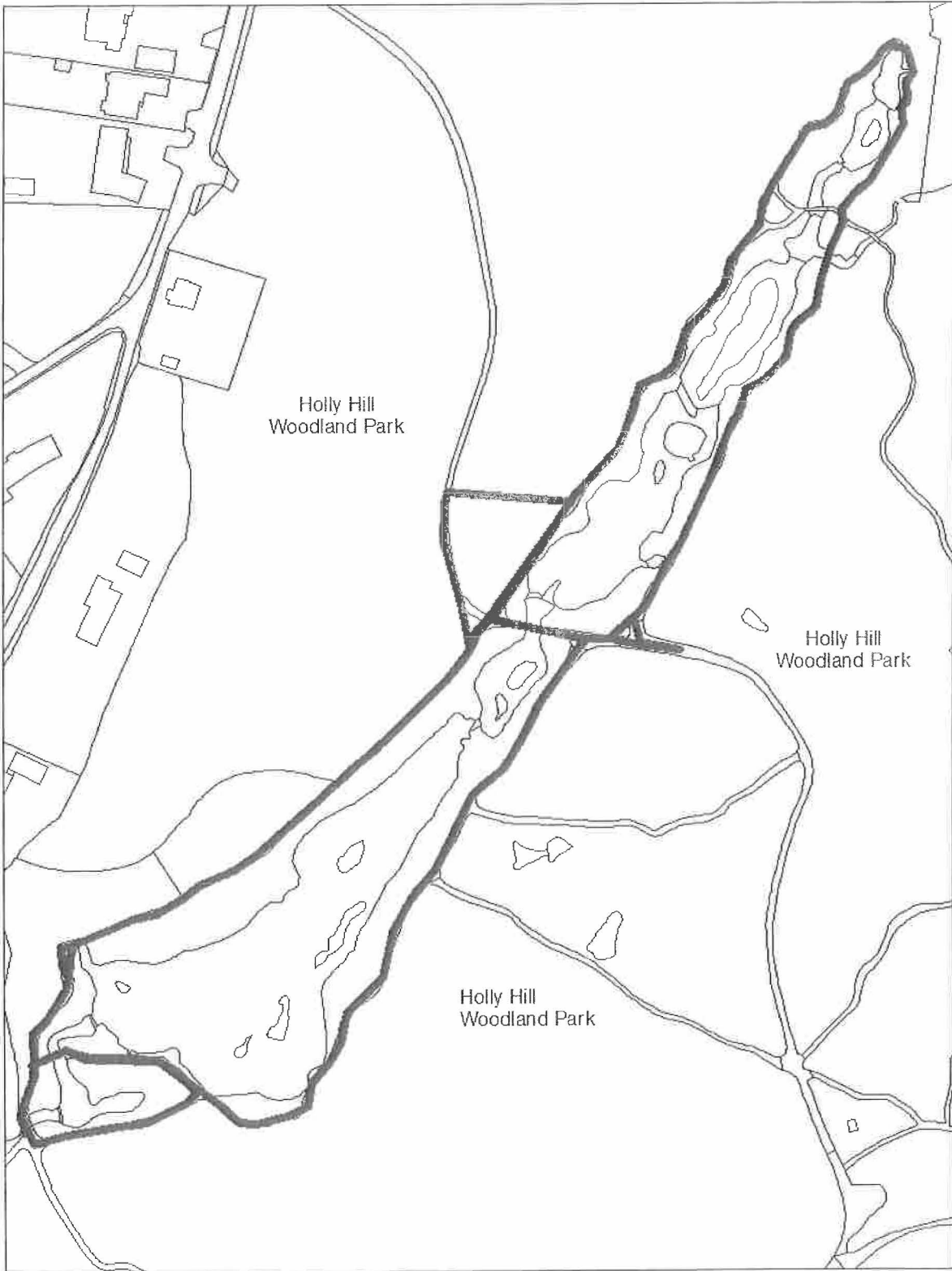

FAREHAM
BOROUGH COUNCIL

Holly Hill Woodland Park, Sarisbury

© Crown copyright and database right 2014 Ordnance Survey. 100019162 You are permitted to use this data for personal or non-commercial purposes only. You are not permitted to copy, distribute, or otherwise make available this data in any form.

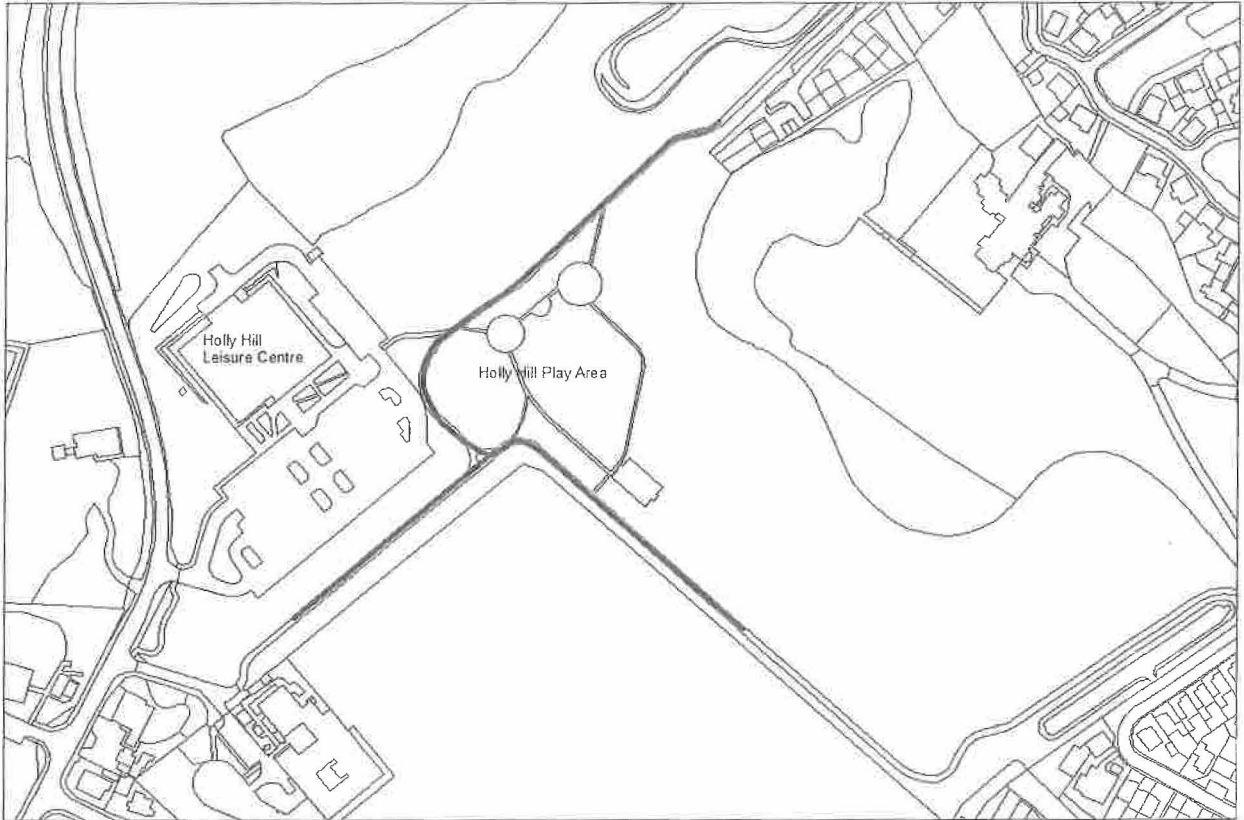

FAREHAM
BC2024 COUNCIL

Holly Hill Play Area

© Crown Copyright and Geographical Information Institute of Great Britain. All rights reserved. This map is reproduced by permission of the Ordnance Survey. It is not to be used for any other purpose without the express permission of the Ordnance Survey.

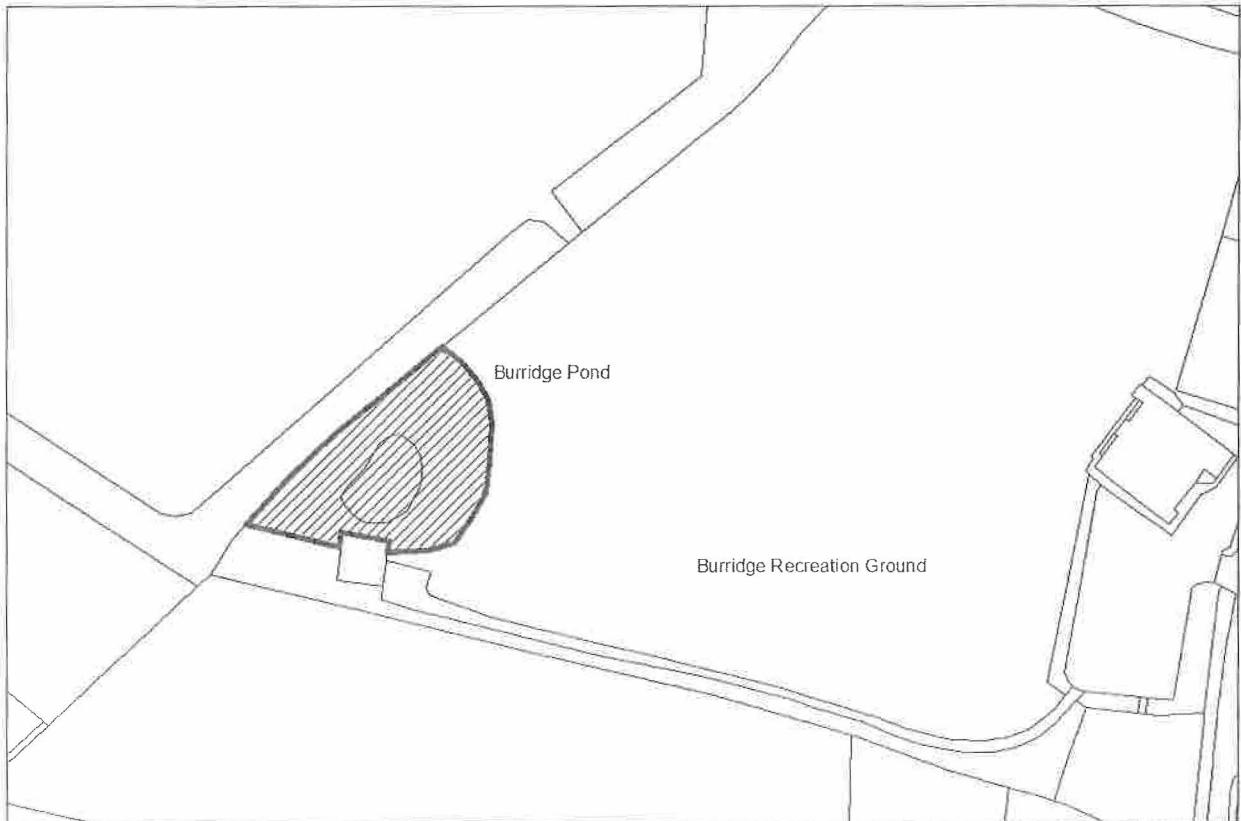

FAREHAM
BC2024 COUNCIL

Burrige Pond, Burrige Recreation Ground

© Crown Copyright and Geographical Information Institute of Great Britain. All rights reserved. This map is reproduced by permission of the Ordnance Survey. It is not to be used for any other purpose without the express permission of the Ordnance Survey.



FAREHAM
BC20061 COUNCIL

Coldeast Open Space

© Crown Copyright and the Controller of Her Majesty's Stationery Office 2019. This map is reproduced with the permission of the Ordnance Survey. It is not to be used for navigation purposes. It is not to be used for any other purpose without the express permission of the Ordnance Survey. All rights reserved.

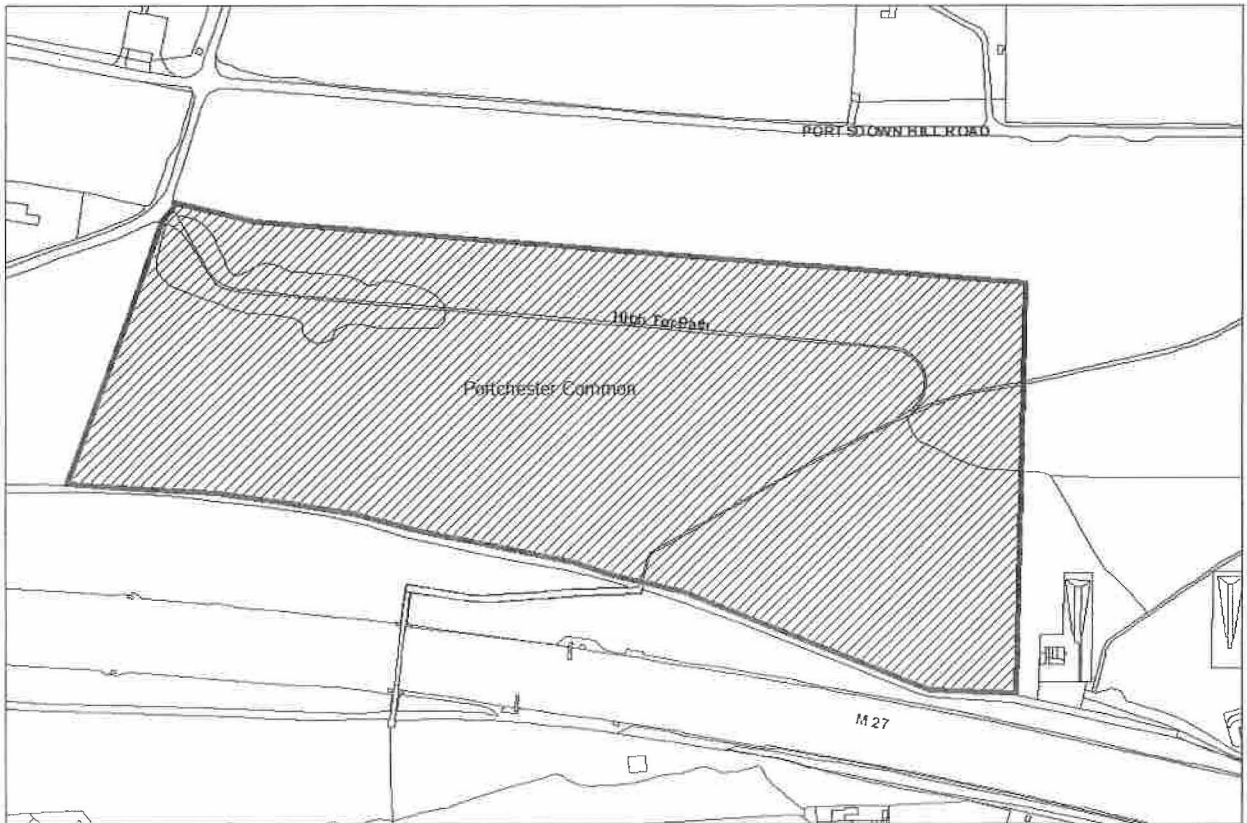

FAREHAM
BC20064 COUNCIL

Portchester Common

© Crown Copyright and the Controller of Her Majesty's Stationery Office 2019. This map is reproduced with the permission of the Ordnance Survey. It is not to be used for navigation purposes. It is not to be used for any other purpose without the express permission of the Ordnance Survey. All rights reserved.

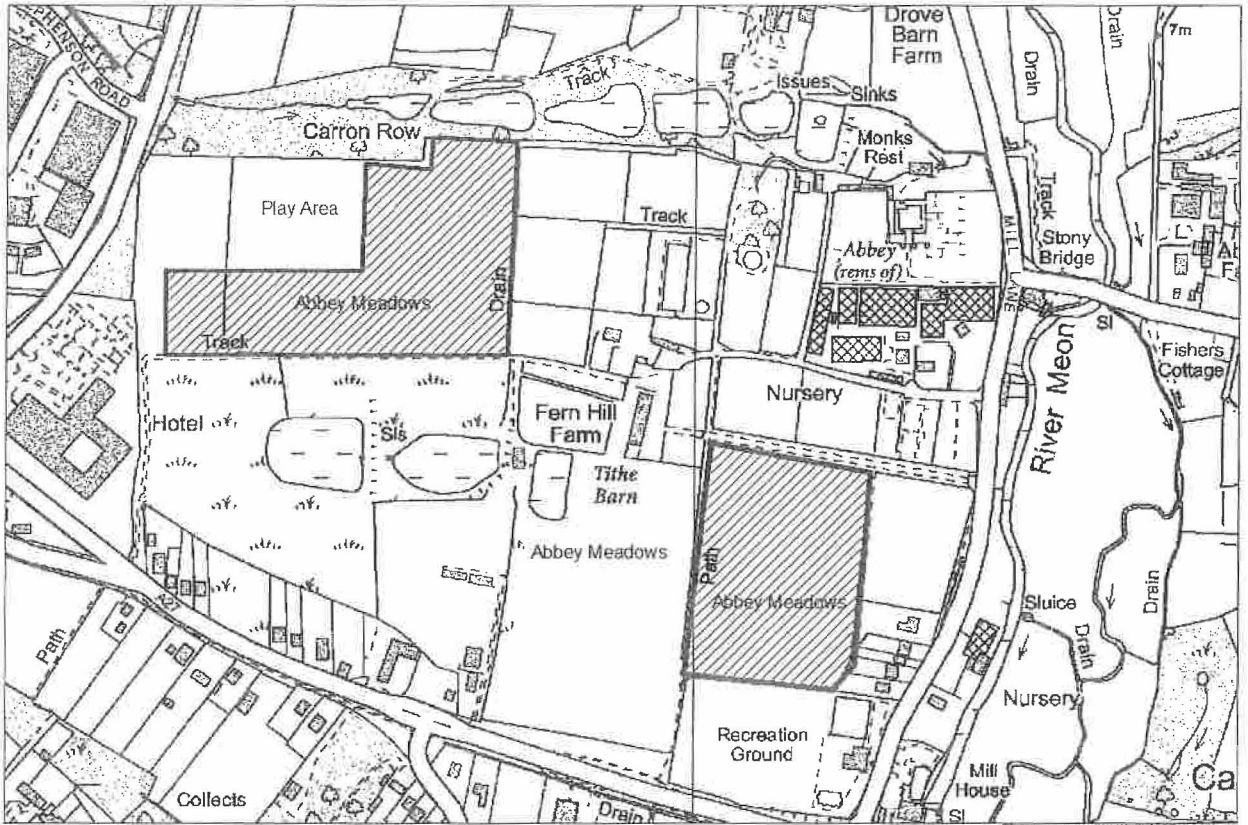

FAREHAM
BOROUGH COUNCIL

Abbey Meadows, Titchfield

© Crown Copyright and the Controller of Her Majesty's Stationery Office
2019. This map is published as a public good and is available for use by anyone.
It is not to be used for any other purpose without the permission of the
Controller. The map is published in digital form and is available for use
on the website www.fareham.gov.uk

SCHEDULE 3

PARAGRAPH 8 EXCLUSION OF DOGS

This Order applies to the following Public Places in the Borough of Fareham

1. Between 1 May and 30 September inclusive in any year the following beach area;
 - i. Any area of beach between the promenade and Low Water Mark of Medium Tides and contained between the points enclosed with notional lines extending from the westernmost of Salterns Road car park and the Borough Boundary with Gosport which is shown outlined in black on the accompanying plan.
2. Any enclosed area designated solely for the purpose of children's play on which there is fixed play equipment or apparatus installed and where signage refers.
3. Any unenclosed area designated for the purpose of children's play on which there is fixed play equipment or apparatus installed and where signage refers. *(please refer to the plan(s))*
 - i. Holly Hill Play Area
 - ii. Abbey Meadows Play Area

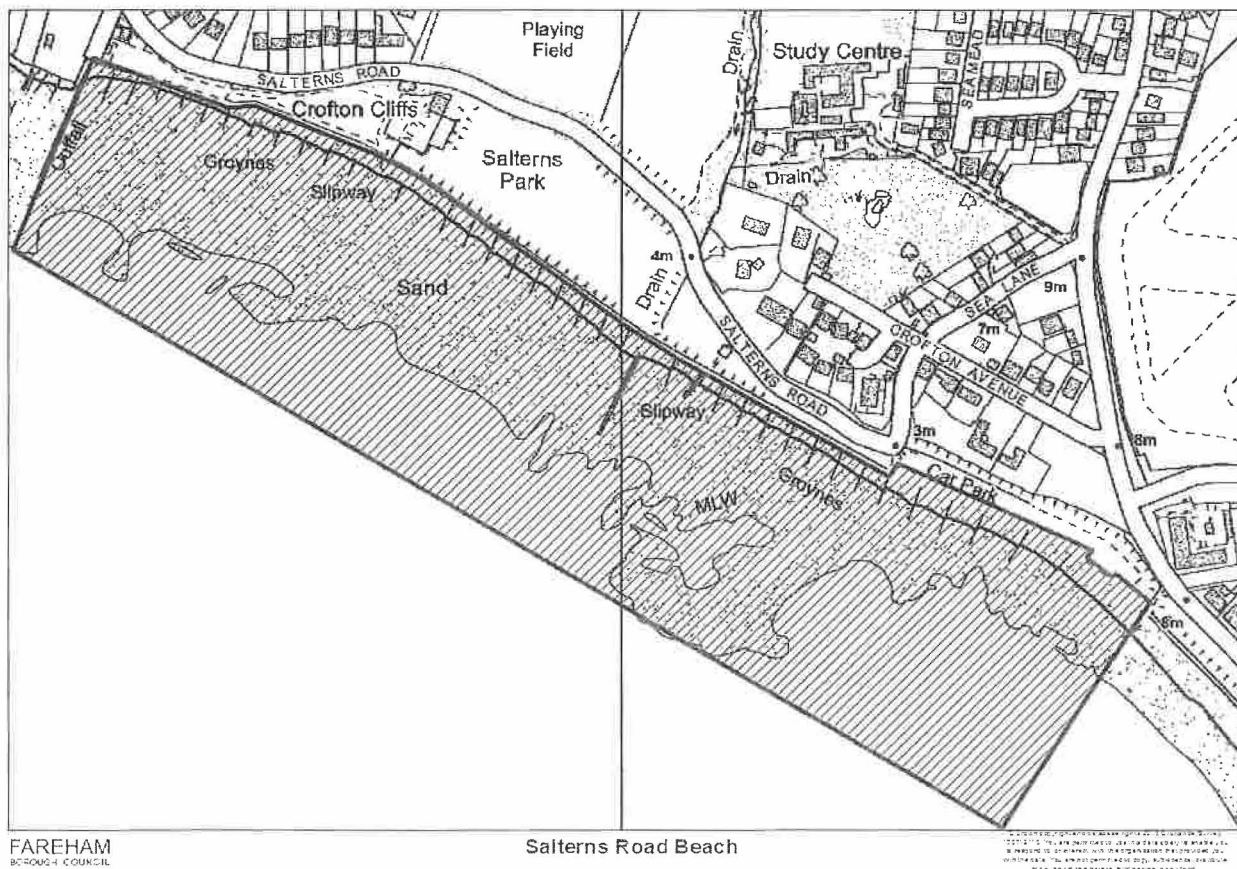



FAREHAM
BOROUGH COUNCIL

Holly Hill Play Area

© Ordnance Survey 2019. All rights reserved. Ordnance Survey Licence No. 100019200. This map is for personal use only. It may not be reproduced, stored in a retrieval system, or transmitted in any form or by any means, electronic, mechanical, photocopying, recording, or otherwise, without the prior written permission of Ordnance Survey. For more information please contact Ordnance Survey on 0300 500050.

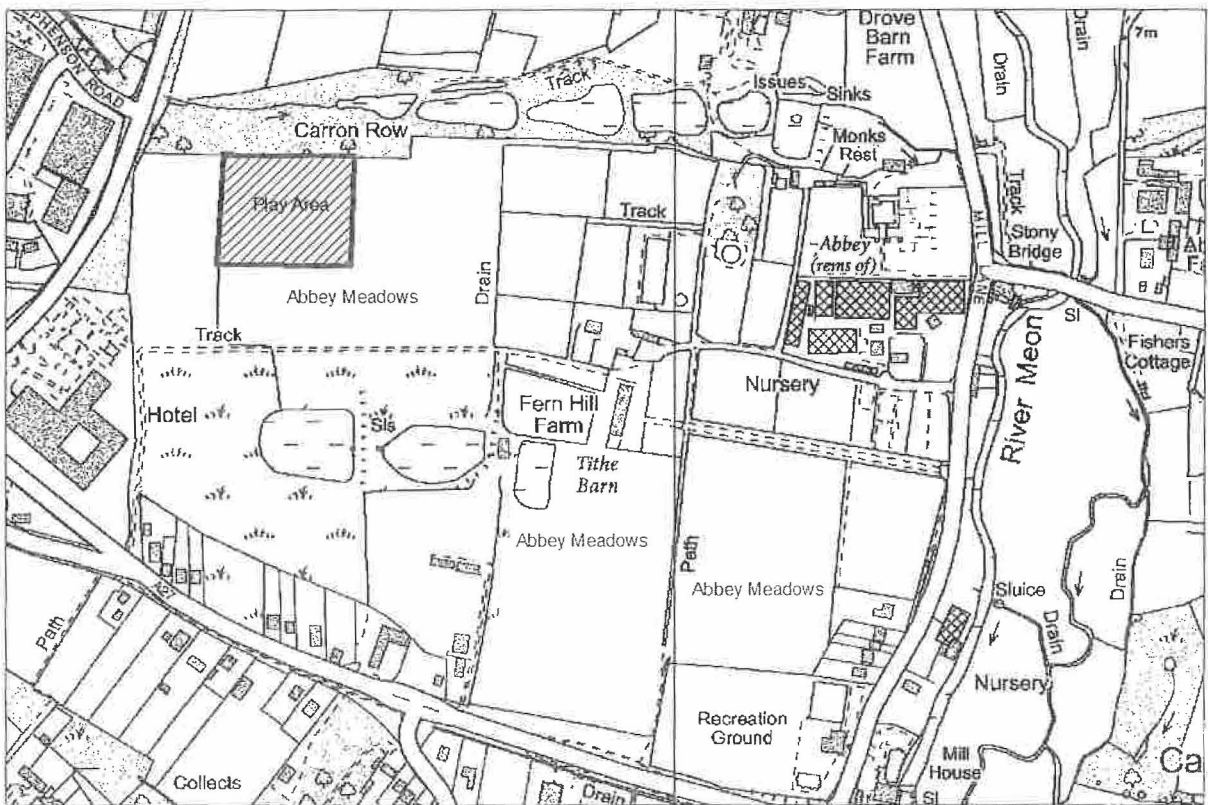

FAREHAM
BOROUGH COUNCIL

Abbey Meadows Play Area, Titchfield

© Ordnance Survey 2019. All rights reserved. Ordnance Survey Licence No. 100019200. This map is for personal use only. It may not be reproduced, stored in a retrieval system, or transmitted in any form or by any means, electronic, mechanical, photocopying, recording, or otherwise, without the prior written permission of Ordnance Survey. For more information please contact Ordnance Survey on 0300 500050.