

Improving Park Lane

Welcome

Fareham Borough Council has started an exciting project to improve Park Lane Recreation Ground.

Have your say

Following a series of community consultations, a vision for improving Park Lane Recreation Ground has been developed.



A bit about Park Lane

Park Lane is one of only a few parks and open space areas within the Fareham Town area. It offers:

- A children's play area
- Skate ramp
- Fareham bowls club
- Four tennis courts
- A series of footpaths
- Open space made up of short grass and a variety of mature



Our vision for Park Lane

Following a series of community consultations, a vision for improving Park Lane Recreation Ground has been developed.

Phase one of the project is now complete and includes:

- A new children's play area
- A new concrete skate park
- Outdoor gym equipment

Phase two of the project will include:

- An all-weather multi-sports facility
- Extensive improvements to the landscape

A map showing the planned changes to the park



A map of the planned changes

The Uplands Arboretum, named to link historically to the Uplands Estate of which the Park was once part. This area already has many significant trees and many more interesting species are to be added to create a aesthetic and educational resource for visitors and schools.

Open area for sports events, casual football, kite flying and rounders.

Enhanced northern entrance with new planting and Knee Rail.

Extension to the existing woodland to create a woodland walk.

All new children's play area set in the sunshine and a large fenced dog free area where families may share picnics, enjoy the gardens and views.

Perennial herbaceous planted in drifts.

Tranquil Garden for outdoor Dance, Yoga and Exercise Classes.

Brand new concrete Skateboard Park for beginners and experts alike.

Possible removal of entrance. State of the art new sports facilities for Basketball, Netball, Tennis, Short Tennis, and Football to be managed by Fareham Leisure Centre. Final layout to be confirmed.

Dense Evergreen planting to screen new sports facilities from houses on Park Lane.

Beech Hedge to Park Lane with timber post and wire fence.

Close access footpath.

Woodland ground cover planting and seasonal bulbs.

Park entrance remodelled and planted to create an attractive feature. Visitors will be welcomed on arrival by Art Work to celebrate the Park.

Outdoor Gym designed for Adults over 16 years of age.

Removal of old fencing and replacement with timber Knee Rail.

The old tennis courts to be replaced with parkland and a new 'off the lead' Dog Exercise Area.

Option to convert old Tennis Courts to new car parking.

A new look entrance to the park from Leigh Road featuring new ornamental shrub planting and hedges with a timber post and wire fence.

Wildflower Meadow and Community Orchard.

A new footpath to take you through the Wildflower and Grassland Meadow.

Native shrub planting to provide a screen between the houses and the park and provide flowers and fruit for insects and birds.

Open area for free sport, casual football, kite flying and rounders.

Resurfacing of the old tennis courts to provide a Basketball Court and Table Tennis.

Remove existing fencing and steps.

New Beech Hedge.

Dense Evergreen planting to screen new sports facilities from houses on Colsenso Road.

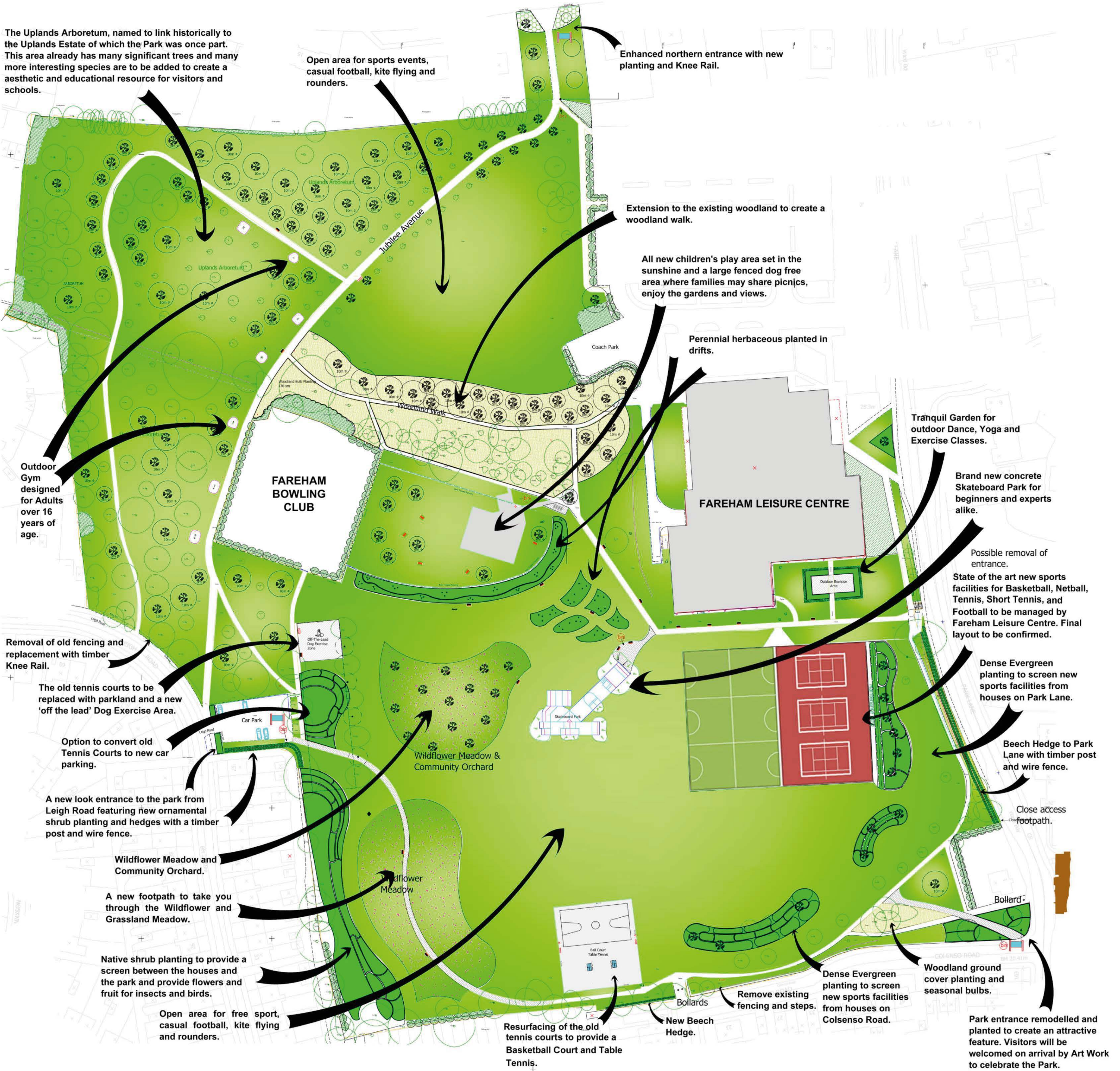

- | | | |
|--|--------------------|--|
| Refuse Bins | Arboretum Tree | Large Arboretum Tree |
| Feature Plants | New Paths | Table Tennis Table |
| Existing Vegetation | Existing Trees | New Seating |
| New Shrub and Herbaceous Planting | New Tree | Interpretation Boards
New Picnic Tables |
| Grass | Tree to be removed | |
| New Wildflower or Woodland Bulb Planting | | |

Children's Play Area

About the children's play area

Installed in 1996, the children's play area features equipment for various ages.

Its current location, underneath the trees, caused the play area surface to become weathered and worn. So, we moved the play area somewhere more visible and easier to get to (see map on board 2).



Getting involved in the new design

Youth Councils at Harrison Primary School and Uplands Infant School told us what they like about the play area, what could be better and which new pieces of equipment they want in the park. They also helped with the overall theme and design.

In response to other suggestions made by residents the play area now:

- Has better fencing
- Is much bigger than the current one
- Includes more play equipment. Some of which will be designed for children with additional needs.
- Has a large grassy picnic seating area



Park Lane's new play area



A better skate park

The current Skate Park

Installed in 2006, with equipment chosen by young people, the skate park has a metal mini ramp featuring a curved rainbow extension and flat bank to wall ride with 25 degree flat transitions. The skate park is extremely popular. Users often tell us they would like more challenging skate facilities locally.

Designed by skaters

We wanted the skate park to be well used by different ages and abilities. That's why we worked with local skaters and BMXers to create a design brief, evaluate the designs and choose the preferred contractor.



The new skate park

The old metal ramp has been removed. The new skate park is located further down the side of the park (see map on board 2). It is made of concrete and landscaped to blend in with the surroundings. Left over soil has been reused for landscaping.



Multi-sports facility

Old Tennis Courts

Park Lane has four tennis courts managed and maintained by Everyone Active (Fareham Leisure Centre) and are free to use. The courts that were at Leigh Road have been converted to a car park.

How the tennis courts in the multi-sports facility could look



How the football pitches in the multi-sports facility could look

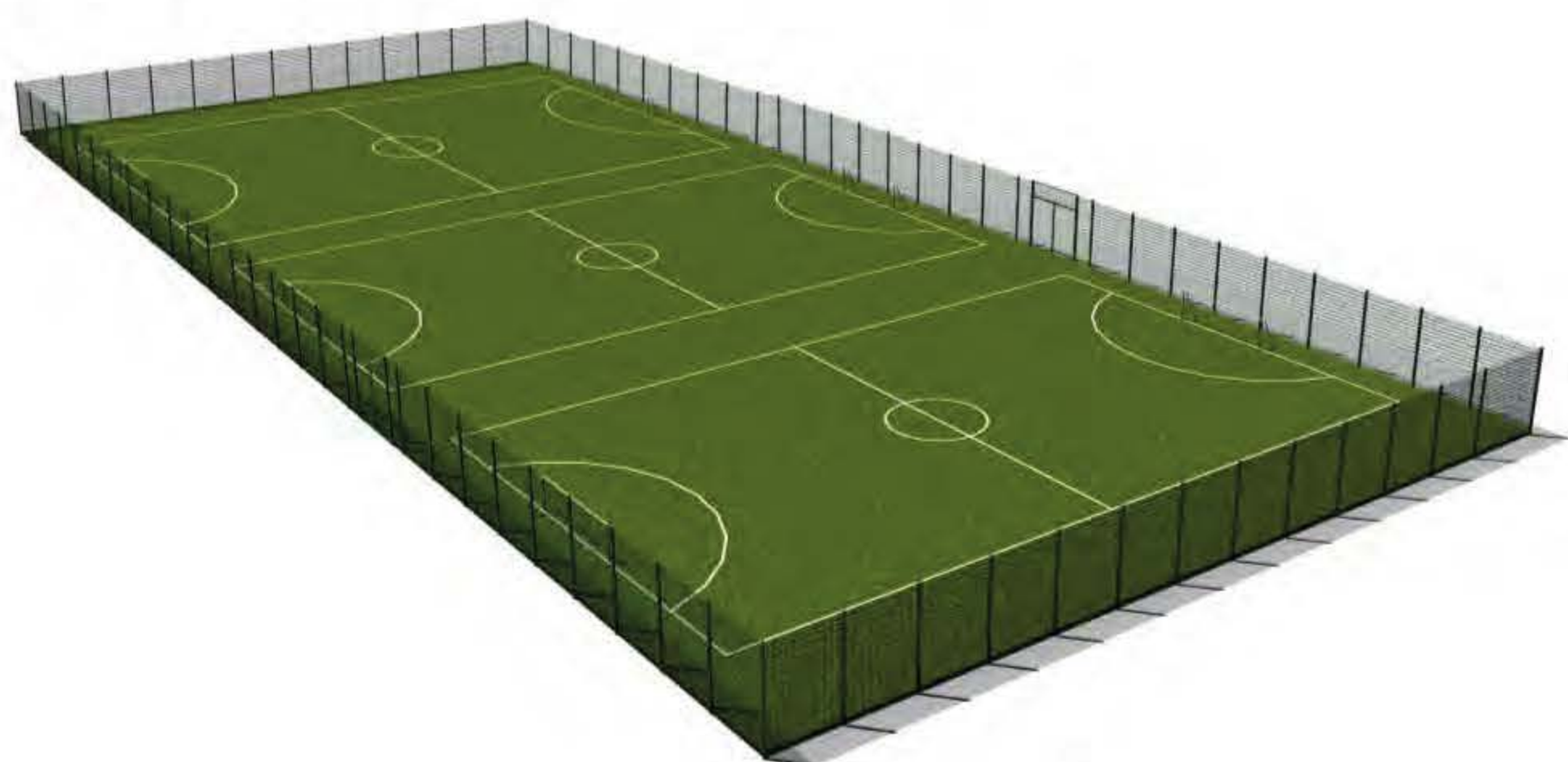

Have your say

We are working to find out whether it would be suitable to build a multi-sports facility in the park and have to take into account lots of factors before we decide to proceed. We will continue to consult with local residents and clubs during this process.

Works would not begin until 2017 and when funding and planning permissions have been agreed.

Please take a look at our proposed illustration above and the size and location of the facility on the map below. Tell us what you think using the comments form.

A photo of the Leigh Road tennis courts



Tennis, Netball and Football for all

We are committed to providing tennis courts at Park Lane and would like to install an all-weather multi-sport facility (see map on board 2). This would replace the existing tennis courts and see those areas either returned back to grass or used in some other way. The multi-sports facility would provide a safe playing area for:

- Tennis
- Netball
- Basketball
- 5-a-side football

Sports all year round

It would be available all year round for public use, clubs and schools. The facility would be managed and maintained in partnership with Everyone Active.

An example of the type of fencing we would like to use for the multi-sports facility



Outdoor fitness

Outdoor Fitness Equipment

Some football training currently takes place in the park. We want to use other parts of the park for outdoor leisure and fitness activities for everyone. There will still be plenty of space for dog walking, kite flying, other sports and community events.



New Gym Equipment

We have installed seven pieces of stainless steel, low impact gym equipment. The equipment is free for all and is suitable for ages 14+. The equipment includes:

- Health walker
- Rower
- Leg press
- Mini ski
- Fitness bike
- Chest press
- Hip twister

An instruction panel with recommended routines for will be provided for each piece of equipment.

Bike Racks

The car parks at Fareham Leisure Centre and Leigh Road are often busy. We know the changes to the park will mean more people wanting to visit.

We want to encourage people to walk or cycle. To help do this, bike racks have been installed outside the children's play area.

Examples of some of the gym equipment



Plants and Landscaping

The Green Landscape

The park's landscape provides a unique opportunity to create an innovative park with modern facilities set amongst traditional landscaping.

Trees and plants from all corners of the globe will be added to the existing trees to create an arboretum (collection of plants) and woodland walk.

Wild flower meadows will be planted to provide a favourable habitat for wildlife and insects. Other planting will see seasonal variation, making the park an attractive place to visit throughout the year and improving with time as the site matures.



Wild Flower Meadows

By allowing the grass to grow, we can encourage the growth of herbs and flowers important to insects. Native (and similar) flowering plants, delicate in appearance and useful for nectar and pollen feeding insects will create a pleasant scene and the chance to observe nature.

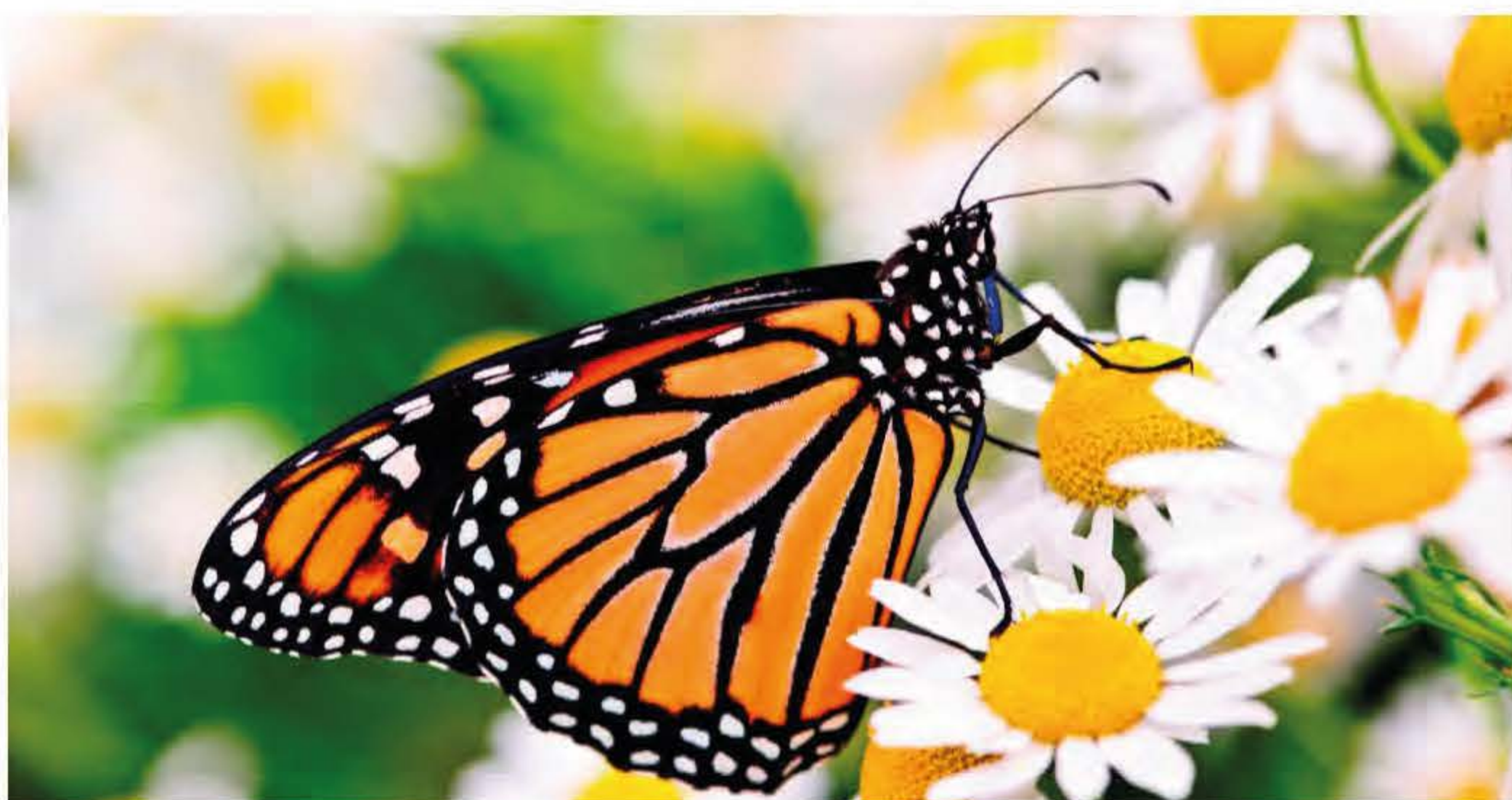

Uplands Arboretum

To the north and west of the park there is a collection of mature trees. We would like to add to these to create an arboretum. The new trees will be from temperate zones around the world and add diversity. You will be able learn about the species and their uses, as well as the cultures of the peoples where they are indigenous.

The Woodland Walk

The mature trees in the centre of the park will be matched by new trees and plants on the other side of the path. The new trees will continue the diversity seen in the arboretum. Woodland plants, both native and garden varieties, will appeal to ourselves and insects.



Buffer Zones

The borders between the children's play area and the skateboard park will be planted with tall grasses and herbaceous plants to flower through them. The borders break up the scale of the park, providing areas to relax away from the sports and play areas, whilst maintaining an overview so that families can stay within sight.

Plants and Landscaping

The Piet Oudolf Borders

Piet Oudolf introduced the idea of large swathes of herbaceous perennial planting, as used in the London Olympic Park. Plants are enjoyed all summer and not cut down in autumn, but left for their fruits, seed heads and winter skeletons which are used by insects as a winter home.

Every care is being taken to choose plants which will succeed in this environment and on this soil. As is the way with planting, some will flourish and some will struggle and the types of plants used will evolve over time.



Screen Planting

We plan to screen the new sports facilities from neighbouring homes by creating an evergreen screen.

Borders will have a spine of hollies to form the screen. This is good cover for roosting and nesting birds. Bold groups of flowering shrubs or small trees will display their stems and beautiful flowers. The full effect will not mature for some years but grow to be strong and elegant.

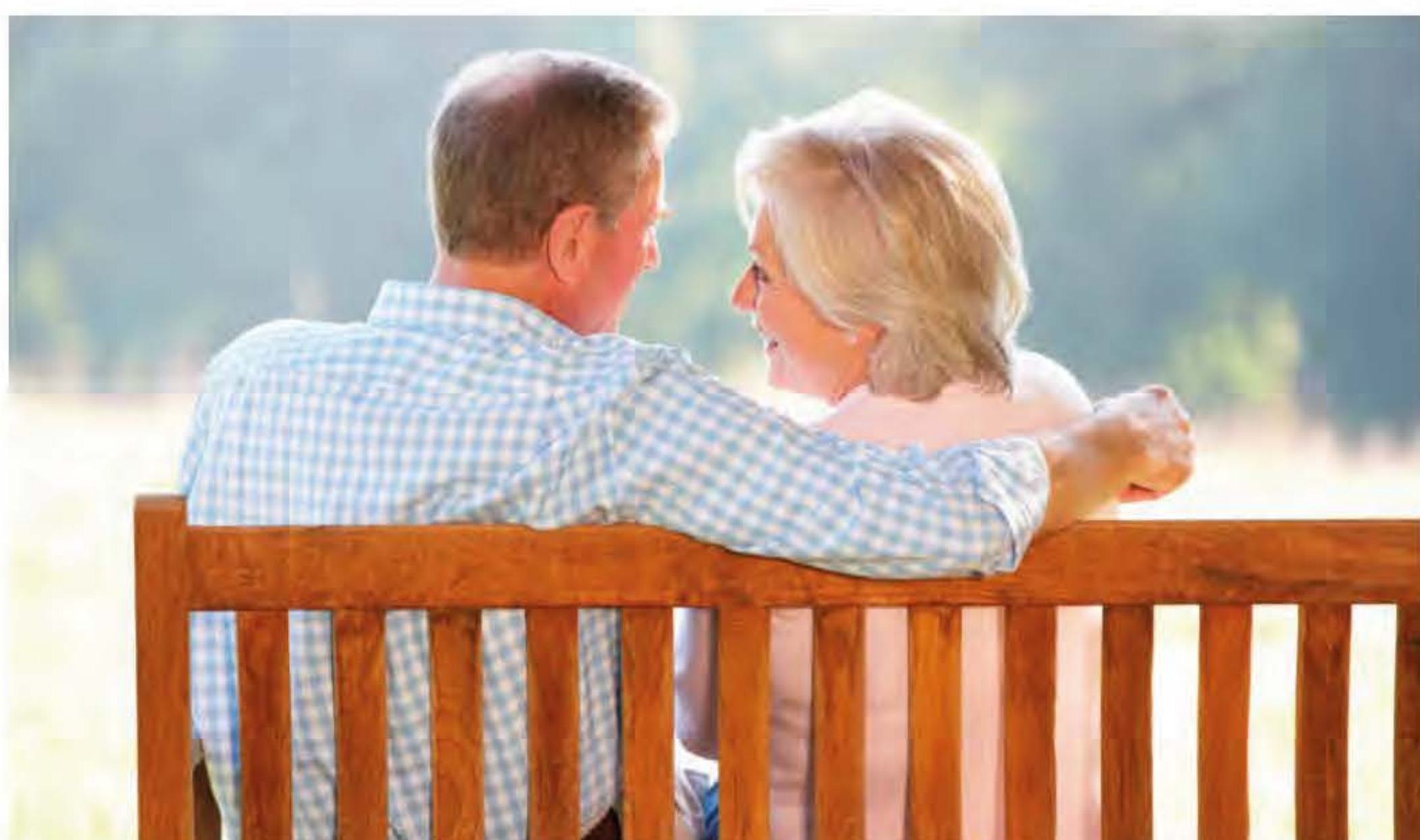

Seating and Rest Areas

We want to create a public space which everyone in the community can enjoy. At the moment, the park can be overlooked and everything seen in one glance. As the new vegetation matures there will be places to sit out of the wind and in the sun or shade, with new views and seats to enjoy.



Wildflower meadows

Weeds and wild flowers will be encouraged in the Wild Flower Meadows. There will be something for everyone with grasses, native plantings, herbaceous plants, new trees and woodland plants.

Pride of Place

In developing horticultural excellence and community participation in the park we would like to get it involved in the highly successful Fareham in Bloom.

This work will include events that encourage participation in the park's development. To improve the visitor experience, there will be educational and interpretative signage which will highlight the different plants and landscapes in the park.

On completion, the site will be entered into South and Southeast England in Bloom as a large park entry, gaining recognition and pride of place.

Plants and Landscaping

The Uplands Arboretum, named to link historically to the Uplands Estate of which the Park was once part. This area already has many significant trees and many more interesting species are to be added to create a aesthetic and educational resource for visitors and schools.

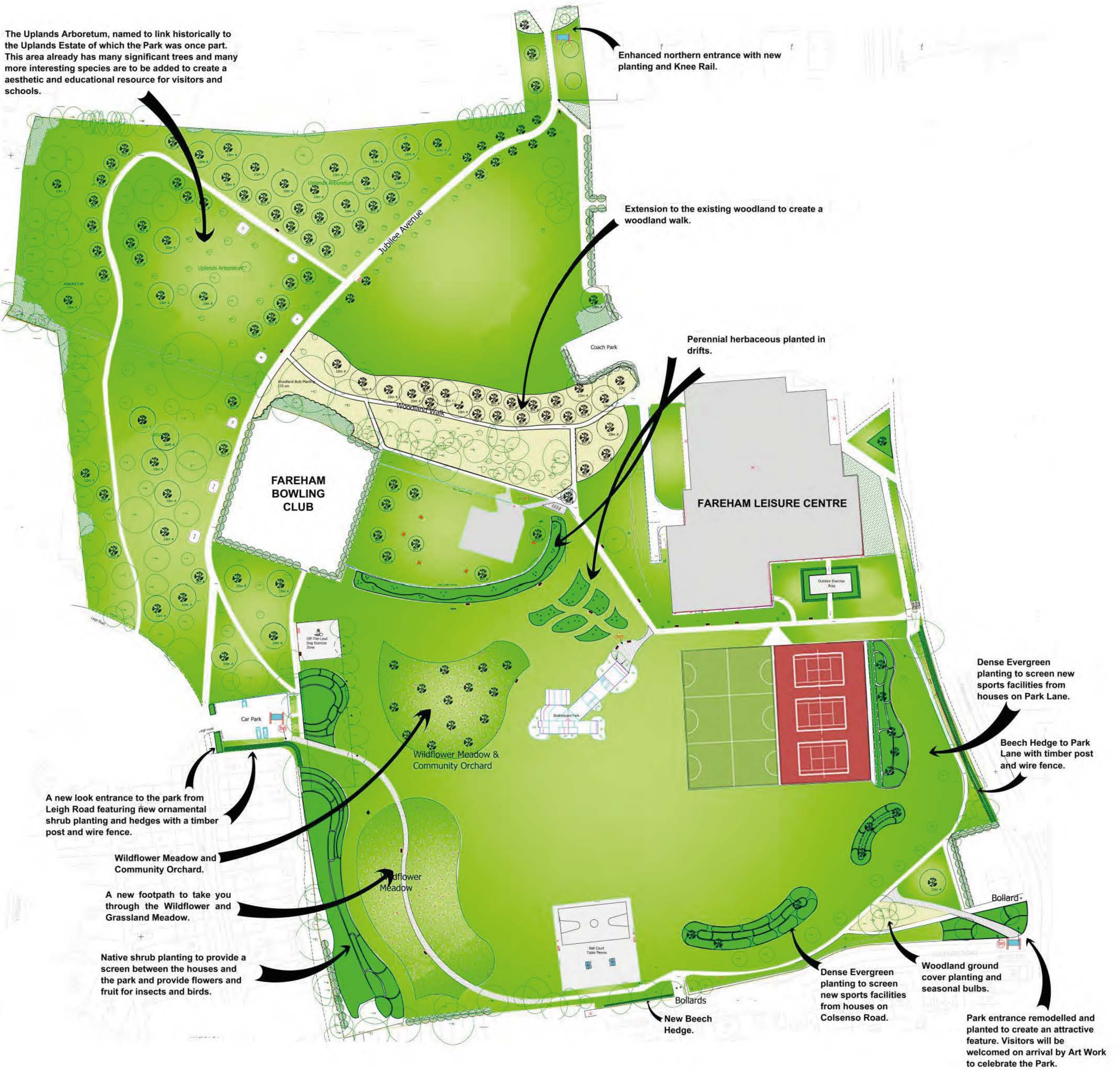

- Refuse Bins
- Feature Plants
- Existing Vegetation
- New Shrub and Herbaceous Planting
- Grass
- New Wildflower or Woodland Bulb Planting
- Arboretum Tree
- New Paths
- Existing Trees
- New Tree
- Tree to be removed
- Large Arboretum Tree
- Table Tennis Table
- New Seating
- Interpretation Boards
New Picnic Tables