

**Meadows South of Burr ridge Road**  
**SU51321063**  
**51-0415**  
**Fareham Borough**

**Habitat Survey**



Date of Survey:	12/05/2020
Written by:	Joel Miller
Validated by:	Sarah Callegari
Date of validation:	02/07/2020
Last reviewed by:	
Date of review:	

## Survey Summary

### Meadows South of Burrige Road 12/05/2020

#### Site Details

<b>Grid Reference :</b>	SU51321063	<b>File Reference :</b>	51-0415
<b>Total Area :</b>	0.7 ha		
<b>District :</b>	Fareham		
<b>Vice-County :</b>	11, South Hampshire		

#### Survey Details

<b>Survey Type :</b>	Phase II
<b>Survey Date :</b>	12/05/2020
<b>Survey Time on Site :</b>	2.75 (hrs)
<b>Data Owned By :</b>	Hampshire Biodiversity Information Centre Partnership
<b>Data Recorded By :</b>	Joel Miller, HBIC

#### Site Summary

The site is comprised of two fields located on the western edge of Burrige. The fields occupy flat ground on a clay, silt and sand superficial. The Upper Hamble Estuary and Woods SSSI lies close by the west of the site. Three similar grassland SINC's lie nearly adjacent to the south of the site.

#### Site Designations

##### Designation

Site of Importance for Nature Conservation

#### Site Features

<u>Type</u>	<u>Description</u>
Management	Mowing

#### Priority Habitats

<u>Priority Habitats</u>	<u>Area</u>
Purple moor grass and rush pasture	
Hedgerows	

#### Notable Species

<u>Taxon Name</u>	<u>Common Name</u>	<u>Status</u>
<i>Senecio aquaticus</i>	Marsh Ragwort	IUCN (EN2014) - Near Threatened

451000

452000

111000

111000

110000

110000

451000

452000

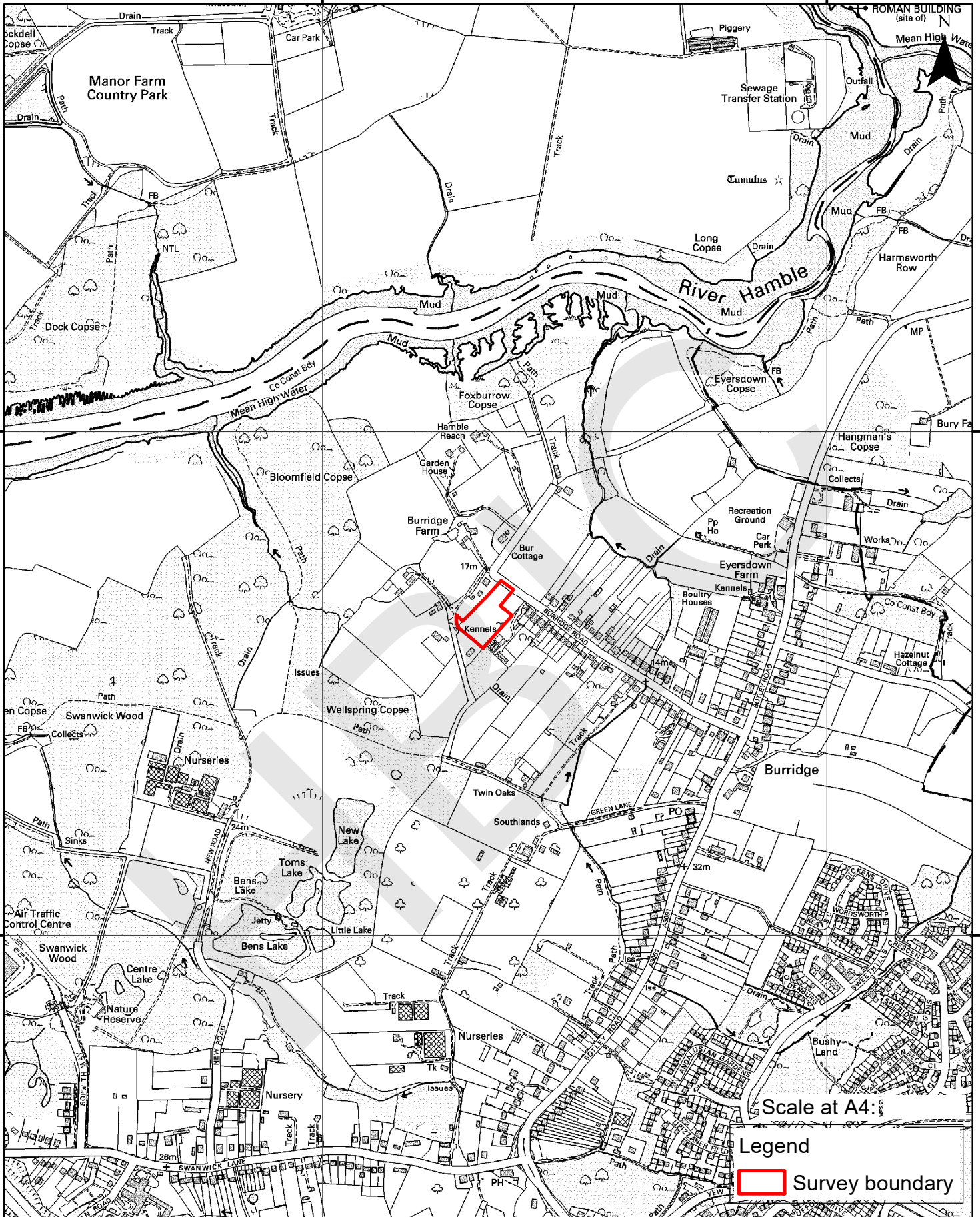

Scale at A4:

Legend

Survey boundary

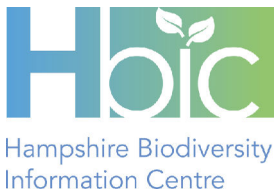

HBIC Survey Programme 2020:

Site Name: Meadows South of Burridge Road

Grid Ref: SU51321063

File Code: 51-0415

© Crown copyright and database rights 2020  
Ordnance Survey [100019180]. Use of this data is subject to terms and conditions.

## **Survey Details**

### **Site Description**

The site is comprised of two fields located on the western edge of Burridge. The fields occupy flat ground on a clay, silt and sand superficial. The Upper Hamble Estuary and Woods SSSI lies close by the west of the site. Three similar grassland SINCs lie nearly adjacent to the south of the site.

The site is split into two fields by a fence. The larger, north-western field supports semi-improved marsh which qualifies as Purple Moor-Grass and Rush-Pasture Priority Habitat. The sward is marshy and supports a fairly good species diversity. There are areas of dryer and more improved grassland present. Overall, the sward has a good presence from rush-pasture and lowland meadow species. Species such as meadow foxtail, creeping buttercup, yorkshire fog, rough meadow-grass, and rushes are prominent. There are also small areas of tall-herb fen and inundation grassland present. A total of 3 grassland indicators were noted within this field, though they are only found rarely.

The southern field has more improved and dryer grassland habitat. The sward has a higher coverage of grasses and a lower coverage of rush-pasture and lowland meadow species. Species such as meadow foxtail, creeping buttercup, rye grass, rough meadow-grass and clovers are prominent. More marshy species are present at the damper margins of the field. 2 grassland indicators were noted at rare frequencies.

There is an overgrown hedgerow along the eastern boundary of the site. A small stretch of hedge-with-trees is located in the south-west corner. Mature pines trees shade the southern fence-line.

### **Management and Condition**

The fields are cut two to three times a year and the arisings removed. The fields had been cut recently prior to the survey being carried out.

#### **2012**

The 2012 survey identified the site as one recently abandoned field. Signs of past heavy grazing and disturbance were noted. Semi-improved marshy grassland was found across the site, along with ruderal species and scrub. Rushes and sedges were especially frequent, but the herb presence was also fairly good. A total of 4 grassland indicators were noted, with hoary ragwort and corky-fruited water-dropwort rating as occasional.

#### **2017**

The survey found the site under regular management. A fence-line had been erected across the field and the north-eastern corner had been developed. The survey was split into North-Western and Southern Field sub-samples.

Due to regular management the site had lost the scrub and ruderal component noted in 2012. The report noted a fairly similar species composition within both fields to the 2012 survey. Species such as buttercups, clovers and selfheal were notably increased but lowland meadow and rush-pasture species were still well represented. However, only 2 grassland indicators were noted, both rarely.

#### **2020**

In the course of three years since the last survey the difference in habitat between the two fields has become much more apparent. The South-Eastern Field shows clear signs of improvement and is now dryer than in 2017, with a more grass dominated sward and a reduced coverage from lowland meadow and rush-pasture species. It has lost a significant level of its wildlife interest.

The reason for the change since the last survey is unclear although the site has been subject to remodelling in the past, which will have impacted the drainage pattern across the field. The ditch along the eastern edge of the field is fairly shallow and shows no sign of recent clearance.

The North-Western Field still retains a diverse marshy habitat. Few soil-led vegetation differences between the two fields were noted within previous surveys, suggesting that the reasons for habitat quality differences are related to management differences between the two fields.

### **Area description**

#### **North-Western Field Sub-Sample**

**Area 1** – MG10v *Holcus lanatus*-*Juncus effusus* rush-pasture, variant **Purple Moor-Grass and Rush-Pasture Priority Habitat** (IHS EM4Z.GM2)

The main part of the field supports a fairly marshy area of rush-pasture. There are tendencies to more improved and dryer sward types in places but overall, the habitat has a good diversity of species.

The sward is composed of meadow foxtail, creeping buttercup, rough meadow-grass, clovers, creeping bent, yorkshire fog, soft rush and creeping cinquefoil. There is also much dandelion, daisy, selfheal, rye grass, hard rush, greater bird's-foot trefoil, tufted hair-grass, glaucous sedge and false fox sedge. Other marsh and lowland meadow present include black knapweed, marsh horsetail, marsh thistle, fleabane, marsh ragwort and wild angelica. Grassland indicators - corky-fruited water-dropwort, stone parsley and hoary ragwort - are found rarely.

A small area to the south-west is dominated by pendulous sedge. There is nearby small area of inundation grassland which is formed of floating sweet-grass and creeping bent.

**Area 2** – OV21 *Poa annua*-*Plantago major* community (IHS GI0.GM2)

This is a small area of gateway vegetation and infilled access track. Rye grass and creeping bent are prominent along with bare ground.

**Area 3** – OV26 *Epilobium hirsutum* community (IHS EM3Z.GM2)

These areas of longer, rougher vegetation support tall-herb fen habitat. This is formed of great willowherb, false oat-grass, stinging-nettle, pendulous sedge, wild angelica, yorkshire fog, herb robert and rushes.

#### **South-Eastern Field Sub-Sample**

**Area 4** – MG1 *Arrhenatherum elatius* grassland (IHS GI0.GM2)

The shaded southern edge of the site has a rougher sward than the rest of the field. The vegetation has some woodland edge species. The sward is composed of false oat-grass, yorkshire fog, herb robert, nipplewort, cleavers and ivy. Stone parsley was noted.

**Area 5** – MG6v *Lolium perenne*-*Cynosurus cristatus* grassland, variant (IHS GI0.GM2)

The grassland within the main part of the field is mostly improved in quality. It does show a similar composition of species to Area 1 in the North-Western Field but there is lower coverage from lowland meadow and marsh species. Grasses are also notably more prominent within the sward.

The main species are meadow foxtail, rye grass, rough meadow-grass, creeping buttercup, daisy, clovers, yorkshire fog, creeping cinquefoil, dandelion and creeping bent. There is a pronounced

coverage of sedges such as pendulous sedge, false fox sedge and glaucous sedge. Lowland meadow and marsh species present include meadow vetchling, tufted hair-grass, common spotted orchid, black knapweed and greater bird's-foot trefoil. Many of the marsh species are restricted to the ditch margin.

There is a small area of localized lowland meadow to the south. Black knapweed, sweet vernal grass, common spotted orchid, marsh thistle and corky-fruited water-dropwort are noted here.

### Hedgerows

- |    |  |  |
|----|--|--|
| H1 | Along the eastern boundary of the South-Eastern Field is an overgrown hedge. The hedge is not very wide and has a garden fence running parallel. It is composed of hawthorn, blackthorn, ash, willow, bramble and ivy. | IHS LF11.LH1.LM32<br>Hedgerow Priority Habitat |
| H2 | This is a small fragment of derelict hedge-with-trees to the south-west. Pine trees are found over blackthorn and hawthorn shrubs.   | IHS LF11.LH1.LM31<br>Hedgerow Priority Habitat |
| H3 | There is an intact hedge, cut hedge at the northern border of the North-Western Field. Blackthorn, hawthorn, willow and bramble are main woody species.  | IHS LF11.LH1.LM12<br>Hedgerow Priority Habitat |



**Photo 1** – Showing South-Eastern Field from the north.



**Photo 2** – Showing central area of North-Western Field.



**Photo 3** – Showing North-Western Field from north-eastern corner.



**Photo 4** – Showing North-Western Field from north-western corner.





**North-Western Field**  
Area 1 - MG10v grassland, variant Priority Habitat  
Area 2 - OV21 community  
Area 3 - OV26 community

**South-Eastern Field**  
Area 4 - MG1 grassland  
Area 5 - MG6v grassland, variant

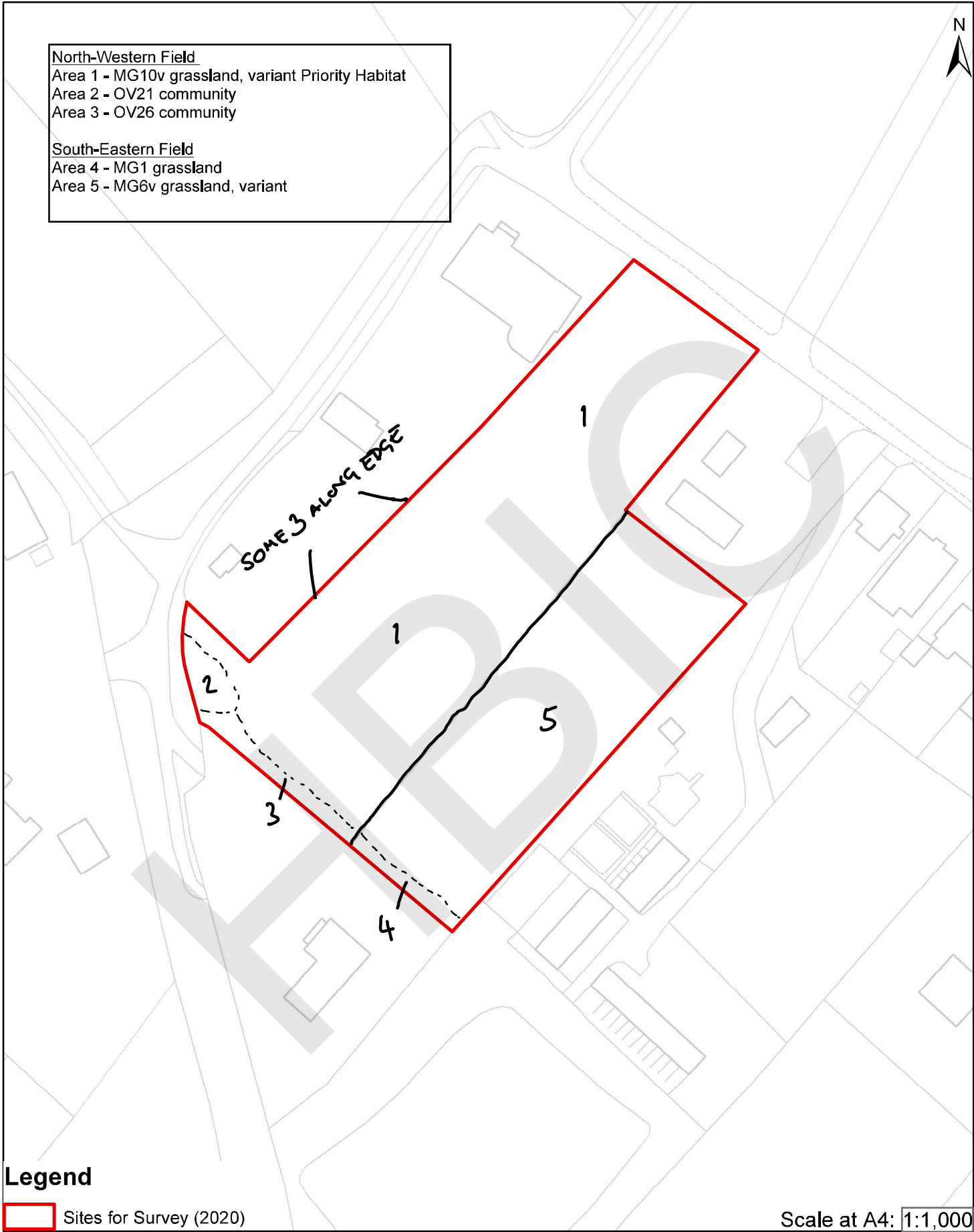

**Legend**

 Sites for Survey (2020)

Scale at A4: 1:1,000



HBIC Survey Programme 2020

Meadows South of Burrige Road  
SU51321063

© Crown copyright and database rights 2020 Ordnance Survey [100019180]. Use of this data is subject to terms and conditions.

(P1) → PHOTOPOINT

(H1) HERBCELOW

CF = CORVY-FRUITED WATER-DROPWORT

HR = HOARY RAGWORT

Si = STONE PARSLEY

SA = MARSH RAGWORT

CSO = COMMON SPOTTED ORCHID

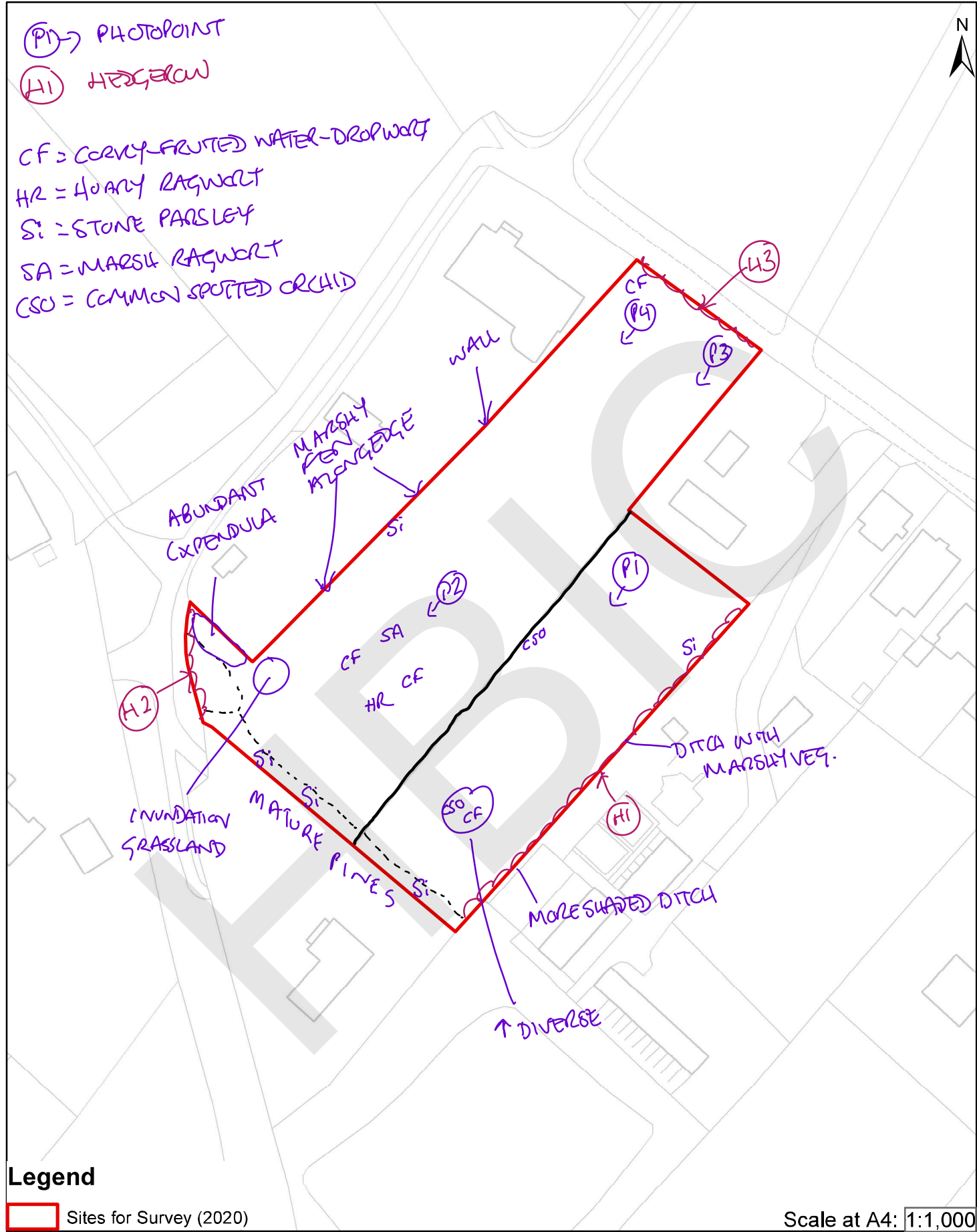

## Survey Details

### Meadows South of Burrige Road 12/05/2020 - Hedges (SU51321063)

#### Habitats Recorded

##### Priority Habitats

Hedgerows

##### Area

#### Species Recorded

<u>Taxon Name</u>	<u>Taxon Common Name</u>	<u>Present</u>	<u>Notable</u>
<i>Acer campestre</i>	Field Maple	P	
<i>Arum maculatum</i>	Lords-and-Ladies	P	
<i>Cornus sanguinea</i>	Dogwood	P	
<i>Crataegus monogyna</i>	Hawthorn	P	
<i>Dryopteris filix-mas</i>	Male-fern	P	
<i>Euonymus europaeus</i>	Spindle	P	
<i>Fraxinus excelsior</i>	Ash	P	
<i>Geum urbanum</i>	Wood Avens	P	
<i>Hedera helix</i>	Ivy	P	
<i>Lonicera periclymenum</i>	Honeysuckle	P	
<i>Pinus</i>	Deal	P	
<i>Prunus laurocerasus</i>	Cherry Laurel	P	
<i>Prunus spinosa</i>	Blackthorn	P	
<i>Quercus robur</i>	Pedunculate Oak	P	
<i>Rosa canina</i>	Dog-rose	P	
<i>Rubus fruticosus</i> agg.	Bramble	P	
<i>Salix cinerea</i>	Common Sallow	P	
<i>Salix euxina x alba = S. x fragilis</i>	Hybrid Crack-willow	P	
<i>Sorbus aucuparia</i>	Rowan	P	
<i>Taxus baccata</i>	Yew	P	

#### Species Summary

**Total no. of species : 20****Note : Indicator species may be present but have not have been flagged or counted as no habitat has been recorded.**

## Survey Details

### Meadows South of Burrige Road 12/05/2020 - North-Western Field (SU51321064)

#### Habitats Recorded

##### Priority Habitats

Purple moor grass and rush pasture

##### Area

##### National Vegetation Classifications

MG10, Holcus lanatus-Juncus effusus rush-pasture

##### Area

OV21, Poa annua-Plantago major community

5 %

OV26, Epilobium hirsutum community

5 %

#### Species Recorded

<u>Taxon Name</u>	<u>Taxon Common Name</u>	<u>Frequency</u>	<u>Notable</u>
<i>Agrostis stolonifera</i>	Creeping Bent	F	
<i>Alopecurus pratensis</i>	Meadow Foxtail	A	
<i>Angelica sylvestris</i>	Wild Angelica	O	
<i>Arrhenatherum elatius</i>	False Oat-grass	RLF	
<i>Bellis perennis</i>	Daisy	F	
<i>Calystegia sepium</i>	Hedge Bindweed	R	
<i>Cardamine flexuosa</i>	Wavy Bitter-cress	R	
<i>Cardamine pratensis</i>	Cuckooflower	R	
<i>Carex flacca</i>	Glaucous Sedge	OLF	
<i>Carex hirta</i>	Hairy Sedge	R	
<i>Carex otrubae</i>	False Fox-sedge	O	
<i>Carex pendula</i>	Pendulous Sedge	OLF	
<i>Carex remota</i>	Remote Sedge	R	
<i>Centaurea nigra sens. lat. (=nigra/debauxii)</i>	Common Knapweed	O	
<i>Cerastium fontanum</i>	Common Mouse-ear	O	
<i>Cirsium arvense</i>	Creeping Thistle	O	
<i>Cirsium palustre</i>	Marsh Thistle	O	
<i>Deschampsia cespitosa</i>	Tufted Hair-Grass	O	
<i>Epilobium hirsutum</i>	Great Willowherb	RLF	
<i>Epilobium parviflorum</i>	Hoary Willowherb	R	
<i>Equisetum palustre</i>	Marsh Horsetail	O	
<i>Fagus sylvatica</i>	Beech	R	
<i>Festuca arundinacea</i>	Tall Fescue	R	
<i>Festuca rubra</i>	Red Fescue	O	
<i>Fraxinus excelsior</i>	Ash	R	
<i>Galium aparine</i>	Cleavers	RLF	
<i>Galium palustre</i>	Marsh-bedstraw	R	
<i>Geranium dissectum</i>	Cut-leaved Crane's-bill	R	
<i>Geranium robertianum</i>	Herb-Robert	R	
<i>Glyceria fluitans</i>	Floating Sweet-grass	RLF	
<i>Heracleum sphondylium</i>	Hogweed	R	
<i>Holcus lanatus</i>	Yorkshire-fog	F	
<i>Hypericum tetrapterum</i>	Square-stalked St John's-wort	R	
<i>Hypochaeris radicata</i>	Cat's-ear	R	
<i>Iris pseudacorus</i>	Yellow Iris	R	
<i>Juncus effusus</i>	Soft-rush	F	
<i>Juncus inflexus</i>	Hard Rush	O	

<u>Taxon Name</u>	<u>Taxon Common Name</u>	<u>Frequency</u>	<u>Notable</u>
<i>Lathyrus pratensis</i>	Meadow Vetchling	R	
<i>Linaria purpurea</i>	Purple Toadflax	R	
<i>Lolium perenne</i>	Perennial Rye-grass	OLF	
<i>Lotus corniculatus</i>	Common Bird's-foot-trefoil	R	
<i>Lotus pedunculatus</i>	Greater Bird's-foot-trefoil	OLF	
<i>Myosotis arvensis</i>	Field Forget-me-not	R	
<i>Myosotis discolor</i>	Changing Forget-me-not	R	
# <i>Oenanthe pimpinelloides</i>	Corky-fruited Water-dropwort	R	
<i>Picris echioides</i>	Bristly Oxtongue	R	
<i>Plantago lanceolata</i>	Ribwort Plantain	O	
<i>Poa trivialis</i>	Rough Meadow-grass	F	
<i>Potentilla reptans</i>	Creeping Cinquefoil	F	
<i>Prunella vulgaris</i>	Selfheal	OLF	
<i>Prunus spinosa</i>	Blackthorn	R	
<i>Pulicaria dysenterica</i>	Common Fleabane	O	
<i>Ranunculus acris</i>	Meadow Buttercup	O	
<i>Ranunculus repens</i>	Creeping Buttercup	A	
<i>Rosa canina</i>	Dog-rose	R	
<i>Rubus fruticosus</i> agg.	Bramble	R	
<i>Rumex acetosa</i>	Common Sorrel	R	
<i>Rumex crispus</i>	Curled Dock	O	
<i>Rumex obtusifolius</i>	Broad-leaved Dock	O	
<i>Salix cinerea</i>	Common Sallow	R	
<i>Salix euxina</i> x <i>alba</i> = <i>S. x fragilis</i>	Hybrid Crack-willow	R	
<i>Senecio aquaticus</i>	Marsh Ragwort	R	Y
# <i>Senecio erucifolius</i>	Hoary Ragwort	R	
<i>Senecio jacobaea</i>	Common Ragwort	R	
# <i>Sison amomum</i>	Stone Parsley	R	
<i>Taraxacum officinale</i> agg.	Dandelion	F	
<i>Trifolium dubium</i>	Lesser Trefoil	O	
<i>Trifolium pratense</i>	Red Clover	O	
<i>Trifolium repens</i>	White Clover	F	
<i>Urtica dioica</i>	Common Nettle	R	
<i>Veronica beccabunga</i>	Brooklime	R	
<i>Vicia cracca</i>	Tufted Vetch	R	

### Species Summary

Total no. of species :	72
# No. of acid/neutral grassland indicators :	3

## Survey Details

### Meadows South of Burrige Road 12/05/2020 - South-Eastern Field (SU51321063)

#### Habitats Recorded

##### National Vegetation Classifications

	<u>Area</u>
MG6, Lolium perenne-Cynosurus cristatus grassland	35 %
MG1, Arrhenatherum elatius grassland	5 %

#### Species Recorded

<u>Taxon Name</u>	<u>Taxon Common Name</u>	<u>Frequency</u>	<u>Notable</u>
<i>Agrostis stolonifera</i>	Creeping Bent	OLF	
<i>Alopecurus pratensis</i>	Meadow Foxtail	A	
<i>Angelica sylvestris</i>	Wild Angelica	R	
<i>Anthoxanthum odoratum</i>	Sweet Vernal-grass	R	
<i>Arrhenatherum elatius</i>	False Oat-grass	RLF	
<i>Bellis perennis</i>	Daisy	F	
<i>Brachypodium sylvaticum</i>	False-brome	R	
<i>Calystegia sepium</i>	Hedge Bindweed	R	
<i>Cardamine pratensis</i>	Cuckooflower	R	
<i>Carex flacca</i>	Glaucous Sedge	OLF	
<i>Carex hirta</i>	Hairy Sedge	R	
<i>Carex otrubae</i>	False Fox-sedge	O	
<i>Carex pendula</i>	Pendulous Sedge	O	
<i>Centaurea nigra sens. lat. (=nigra/debauxii)</i>	Common Knapweed	R	
<i>Cerastium fontanum</i>	Common Mouse-ear	R	
<i>Cirsium arvense</i>	Creeping Thistle	R	
<i>Cirsium palustre</i>	Marsh Thistle	R	
<i>Dactylis glomerata</i>	Cock's-foot	O	
<i>Dactylorhiza fuchsii</i>	Common Spotted-orchid	R	
<i>Daucus carota</i>	Carrot	R	
<i>Deschampsia cespitosa</i>	Tufted Hair-Grass	O	
<i>Equisetum palustre</i>	Marsh Horsetail	R	
<i>Festuca arundinacea</i>	Tall Fescue	R	
<i>Festuca rubra</i>	Red Fescue	O	
<i>Galium aparine</i>	Cleavers	R	
<i>Geranium robertianum</i>	Herb-Robert	R	
<i>Hedera helix</i>	Ivy	RLF	
<i>Holcus lanatus</i>	Yorkshire-fog	OLF	
<i>Hypericum tetrapterum</i>	Square-stalked St John's-wort	R	
<i>Hypochaeris radicata</i>	Cat's-ear	R	
<i>Iris pseudacorus</i>	Yellow Iris	R	
<i>Juncus effusus</i>	Soft-rush	O	
<i>Lapsana communis</i>	Nipplewort	R	
<i>Lathyrus pratensis</i>	Meadow Vetchling	R	
<i>Leucanthemum vulgare</i>	Oxeye Daisy	R	
<i>Lolium perenne</i>	Perennial Rye-grass	FLA	
<i>Lotus pedunculatus</i>	Greater Bird's-foot-trefoil	R	
<i>Myosotis arvensis</i>	Field Forget-me-not	R	
<i>Myosotis discolor</i>	Changing Forget-me-not	R	
# <i>Oenanthe pimpinelloides</i>	Corky-fruited Water-dropwort	R	
<i>Persicaria hydropiper</i>	Water-pepper	R	

<u>Taxon Name</u>	<u>Taxon Common Name</u>	<u>Frequency</u>	<u>Notable</u>
<i>Picris echioides</i>	Bristly Oxtongue	R	
<i>Plantago lanceolata</i>	Ribwort Plantain	O	
<i>Plantago major</i>	Greater Plantain	O	
<i>Poa annua</i>	Annual Meadow-grass	R	
<i>Poa trivialis</i>	Rough Meadow-grass	F	
<i>Potentilla anserina</i>	Silverweed	RLF	
<i>Potentilla reptans</i>	Creeping Cinquefoil	OLF	
<i>Primula vulgaris</i>	Primrose	R	
<i>Prunella vulgaris</i>	Selfheal	OLF	
<i>Pulicaria dysenterica</i>	Common Fleabane	R	
<i>Ranunculus acris</i>	Meadow Buttercup	R	
<i>Ranunculus repens</i>	Creeping Buttercup	FLA	
<i>Rubus fruticosus</i> agg.	Bramble	R	
<i>Rumex acetosa</i>	Common Sorrel	R	
<i>Rumex conglomeratus</i>	Clustered Dock	R	
<i>Rumex crispus</i>	Curled Dock	R	
<i>Rumex obtusifolius</i>	Broad-leaved Dock	R	
<i>Salix cinerea</i>	Common Sallow	R	
# <i>Sison amomum</i>	Stone Parsley	R	
<i>Sonchus asper</i>	Prickly Sow-thistle	R	
<i>Taraxacum officinale</i> agg.	Dandelion	OLF	
<i>Trifolium dubium</i>	Lesser Trefoil	RLF	
<i>Trifolium hybridum</i>	Alsike Clover	RLF	
<i>Trifolium pratense</i>	Red Clover	O	
<i>Trifolium repens</i>	White Clover	F	
<i>Urtica dioica</i>	Common Nettle	R	
<i>Vicia sativa</i>	Common Vetch	R	
<i>Vicia tetrasperma</i>	Smooth Tare	R	

## Species Summary

<b>Total no. of species :</b>	<b>69</b>
<b># No. of acid/neutral grassland indicators :</b>	<b>2</b>

## Notes

### Habitat Classifications :

Priority: Habitats identified as the highest priority for conservation action in the UK

NVC: A system of classifying natural habitat communities according to species associations

Phase 1: A standardised system for surveying, classifying and mapping broad wildlife habitats including urban areas

Peterken: A stand type classification that describes woodlands by tree species

### Indicators Species :

- \* Ancient Woodland Vascular Plants (AWVP) - species most strongly associated with ancient woodland and are typical components of botanically rich ancient woodland communities
- # Acid/neutral grassland indicators - species which seldom occur outside of unimproved acid/neutral grasslands or are indicative of a long period of uninterrupted grassland management
- ~ Chalk grassland indicators - species characteristic of unimproved chalk downland or have a strong affinity to calcareous soil

### Species Abundance:

Frequency: D=dominant A=abundant F=frequent O=occasional R=rare L=locally

Frequencies within brackets ( ) indicate non-native occurrences

### Habitat and Species designations and statuses:

Habitat designations/categories and species legislation/statuses are correct at the time the report was generated and may not necessarily reflect those applicable either at the time of survey or later than the generated date.