

MAX LEGAL ARTICULATED VEHICLE (16.5m)

SCALE 1:400

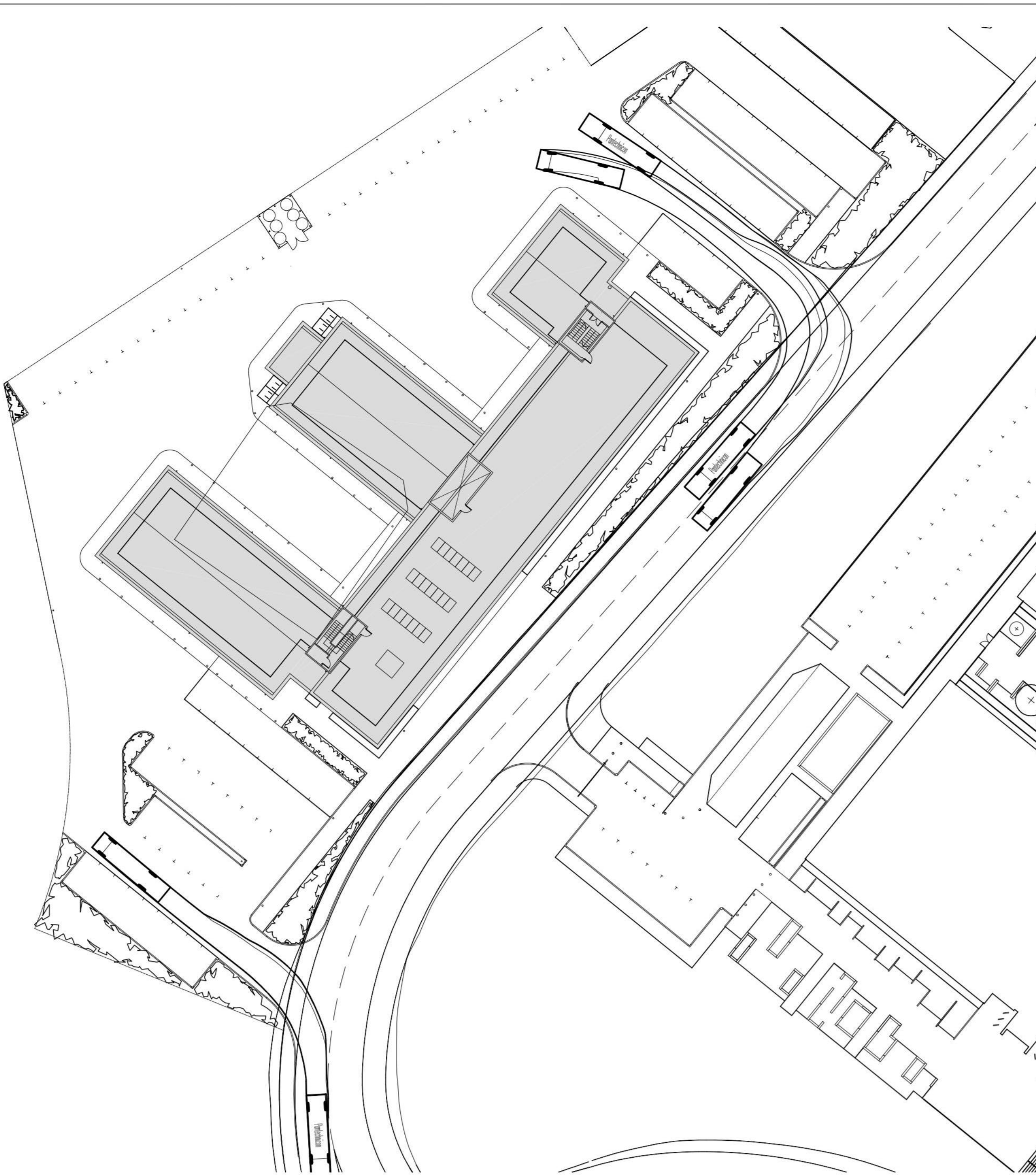

LARGE FIXED WHEELBASE LORRY (11m)

SCALE 1:400

- Notes**
1. THIS DRAWING IS TO BE READ IN CONJUNCTION WITH ALL RELEVANT ENGINEERS AND ARCHITECTS DRAWINGS.
 2. ALL DIMENSIONS ARE IN MILLIMETRES AND LEVELS ARE IN METRES UNLESS NOTED OTHERWISE.
 3. CONTRACTOR TO CONFIRM ALL DIMENSIONS ON SITE. ANY DISCREPANCIES TO BE ADVISED TO THE ENGINEER.
 4. DRAWING STATUS DEFINITIONS:—

P01 — PRELIMINARY — FOR INFORMATION ONLY (NOT TO BE USED FOR CONSTRUCTION).

T01 — TENDER — FOR TENDER / INFORMATION ONLY (NOT TO BE USED FOR CONSTRUCTION).

D01 — DESIGN DEVELOPMENT — FOR INFORMATION ONLY (NOT TO BE USED FOR CONSTRUCTION).

C01 — CONSTRUCTION — FOR INFORMATION / PROCUREMENT / CONSTRUCTION.

Z01 — AS BUILT — FOR INFORMATION ONLY.

FAREHAM BOROUGH COUNCIL
Development Management

25 MAR 2014
REF P/14/0081/FP

APPROVE
02-MAY-2014

P02	REVISED TRACKING	TP	RH	RH	25.03.14
P01	PRELIMINARY	TP	RH	RH	06.03.14
Rev.	Amendment	Dm.	Chkd.	Appd.	Date

Project
**INNOVATION CENTRE
FAREHAM**

Drawing
**VEHICLE TRACKING
VEHICLES ENTERING AND EXITING
SITE IN FORWARD GEAR**

Client
BOUYGUES

Scott White and Hookins

Civil/Structural Engineers Health and Safety Approved Inspectors Geomatic Engineering

Harman House, Andover Road, Winchester, Hampshire SO23 7BS
T: +44 (0)1962 844855 F: +44 (0)1962 841328 www.swh.co.uk

Scale at A1 - 1:200	Status: PRELIMINARY
Project / Drawing No. W00685-401	Rev. P02

WNFM/310/09

DO NOT SCALE FROM THIS DRAWING